

# Massachusetts Cultural Resource Information System

## Scanned Record Cover Page

<b>Inventory No:</b>	SBR.195
<b>Historic Name:</b>	Southborough Poor Farm
<b>Common Name:</b>	Dorr House
<b>Address:</b>	98 Southville Rd
<b>City/Town:</b>	Southborough
<b>Village/Neighborhood:</b>	Cordaville
<b>Local No:</b>	277-4-35
<b>Year Constructed:</b>	c 1850
<b>Architect(s):</b>	
<b>Architectural Style(s):</b>	No style
<b>Use(s):</b>	Poor House or Almshouse; Single Family Dwelling House
<b>Significance:</b>	Agriculture; Architecture; Community Planning; Social History
<b>Area(s):</b>	SBR.C: Cordaville
<b>Designation(s):</b>	
<b>Building Materials(s):</b>	Roof: Asphalt Shingle Wall: Aluminum Siding; Wood Foundation: Concrete Unspecified; Stone, Uncut



The Massachusetts Historical Commission (MHC) has converted this paper record to digital format as part of ongoing projects to scan records of the Inventory of Historic Assets of the Commonwealth and National Register of Historic Places nominations for Massachusetts. Efforts are ongoing and not all inventory or National Register records related to this resource may be available in digital format at this time.

The MACRIS database and scanned files are highly dynamic; new information is added daily and both database records and related scanned files may be updated as new information is incorporated into MHC files. Users should note that there may be a considerable lag time between the receipt of new or updated records by MHC and the appearance of related information in MACRIS. Users should also note that not all source materials for the MACRIS database are made available as scanned images. Users may consult the records, files and maps available in MHC's public research area at its offices at the State Archives Building, 220 Morrissey Boulevard, Boston, open M-F, 9-5.

Users of this digital material acknowledge that they have read and understood the MACRIS Information and Disclaimer (<http://mhc-macris.net/macrisdisclaimer.htm>)

Data available via the MACRIS web interface, and associated scanned files are for information purposes only. THE ACT OF CHECKING THIS DATABASE AND ASSOCIATED SCANNED FILES DOES NOT SUBSTITUTE FOR COMPLIANCE WITH APPLICABLE LOCAL, STATE OR FEDERAL LAWS AND REGULATIONS. IF YOU ARE REPRESENTING A DEVELOPER AND/OR A PROPOSED PROJECT THAT WILL REQUIRE A PERMIT, LICENSE OR FUNDING FROM ANY STATE OR FEDERAL AGENCY YOU MUST SUBMIT A PROJECT NOTIFICATION FORM TO MHC FOR MHC'S REVIEW AND COMMENT. You can obtain a copy of a PNF through the MHC web site ([www.sec.state.ma.us/mhc](http://www.sec.state.ma.us/mhc)) under the subject heading "MHC Forms."

Commonwealth of Massachusetts  
Massachusetts Historical Commission  
220 Morrissey Boulevard, Boston, Massachusetts 02125  
[www.sec.state.ma.us/mhc](http://www.sec.state.ma.us/mhc)

This file was accessed on:

Saturday, July 09, 2016 at 2:34: PM

# FORM B - BUILDING

Assessor's Number

USGS Quad

Area(s)

Form Number

Massachusetts Historical Commission  
80 Boylston Street

277/4/35

Marlborough

195

Town Southborough

Place (neighborhood or village) Cord

Cordaville

Address 98 Southville Road

Historic Name

Uses: Present Residence

Original Residence

Date of Construction ca. 1860

Source Town Assessor's Office

Style/Form

Architect/Builder

Exterior Material:

Foundation Concrete

Wall/Trim Vinyl siding

Roof Asphalt shingle

Outbuildings/Secondary Structures

Major Alterations (with dates)

Condition Fair

Moved ☐ no ☐ yes Date

Acreage 3 acres

Setting North of the Boston-

Worcester Railroad, in a residential

community.



buildings between inventoried building and nearest intersection or natural feature. Label streets including route numbers, if any. Circle and number the inventoried building. Indicate north.

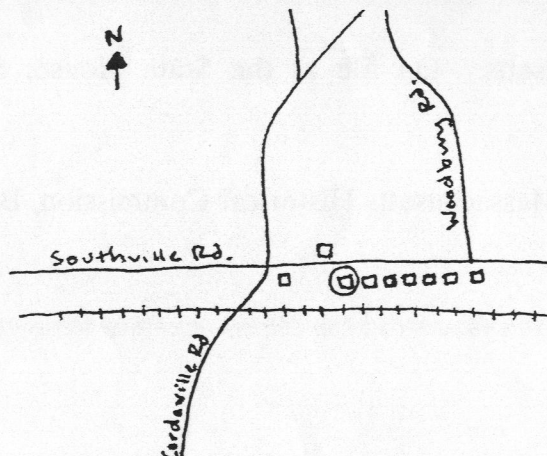

Recorded by Barbara Putnam and Rachel Smith

Organization Timelines, Inc.

Date (month/year) 1/95

## BUILDING FORM

ARCHITECTURAL DESCRIPTION ☐ *see continuation sheet*

*Describe architectural features. Evaluate the characteristics of this building in terms of other buildings within the community.*

Rising from a concrete foundation, 98 Southville Road is a rectangular, symmetrical, two-and-a-half-story side-gable residence. The building is two bays deep and the windows, which are new, have retained their original surrounds. The exterior of the building is wood frame, but the wood paneling has been replaced with vinyl siding. The side-gable roof is boxed, has a slight overhang with a band of wood trim, and is covered with asphalt shingles. There are two paired interior brick chimneys. This building is in a residential area and is abutted by buildings of similar age and style.

HISTORICAL NARRATIVE ☐ *see continuation sheet*

*Discuss the history of the building. Explain its associations with local (or state) history. Include uses of the buildings, and the role(s) the owners/occupants played within the community.*

98 Southville Road was constructed during the Early Industrial Period (1830-1870) when Southborough's population increased as the Boston and Worcester Turnpike and the Boston-Worcester Railroad provided a means of transporting industry from Boston to more rural areas. Agriculture remained a large portion of Southborough's economy, but industrial villages arose in Southville and Cordaville, resulting in the construction of residential buildings along Southville Road to house the growing population of the town.

BIBLIOGRAPHY and/or REFERENCES ☐ *see continuation sheet*

Bailey, O. H.

1887 Map of Southville and Cordaville, Massachusetts. On file at the State House: Special Collections.

Massachusetts Historical Commission

1983 *Reconnaissance Survey Report: Southborough*. Massachusetts Historical Commission, Boston.

☐ Recommended for listing in the National Register of Historic Places. *If checked, you must attach a completed National Register Criteria Statement Form.*



PL CARD  
195

C



own Southborough

street address 98 Southville Rd.

name \_\_\_\_\_

use: original & present dwelling / Poor farm

present owner R.E. Leahy

open to public \_\_\_\_\_

date pre 1831 Style \_\_\_\_\_

source of date Pre 1831 Map

architect \_\_\_\_\_

Architectural reason for inventorying:  
Pre 1870 - old poor farm

OR part of Area # \_\_\_\_\_

3. CONDITION Excellent Good Fair Deteriorated Moved Altered Added \_\_\_\_\_

#### 4. DESCRIPTION

FOUNDATION/BASEMENT: High Regular Low Material Fieldstone

WALL COVER: Wood Clapboard (possibly aluminum) Brick Stone Other \_\_\_\_\_

ROOF: Ridge Gambrel Flat Hip Mansard  
 Tower Cupola Dormer windows Balustrade Grillwork \_\_\_\_\_

CHIMNEYS: 1 2 3 4 Center End Interior Irregular Cluster Elaborate

STORIES: 1 2 3 4 ATTACHMENTS: Wings Ell Shed \_\_\_\_\_

PORCHES: 1 2 3 4 \_\_\_\_\_ PORTICO \_\_\_\_\_ Balcony

FACADE: Gable end: Front/side Ornament \_\_\_\_\_

Entrance: Side Front: Center/Side Details: \_\_\_\_\_

Windows: Spacing: Regular/Irregular Identical/Varied

Corners: Plain Pilasters Quoins Cornerboards \_\_\_\_\_

5. Indicate location of building in relation to nearest cross streets and other buildings

6. Footage of structure from street \_\_\_\_\_  
 Property has \_\_\_\_\_ feet frontage on street

Recorder \_\_\_\_\_

For \_\_\_\_\_

Photo # 5-19 Date 1971

SEE REVERSE SIDE

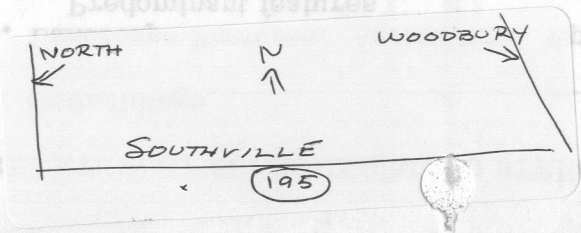

1. Outbuildings \_\_\_\_\_
2. Landscape Features: Agriculture \_\_\_\_\_ Open Wooded Garden: Formal/Informal \_\_\_\_\_  
 Predominant features \_\_\_\_\_  
 Landscape architect \_\_\_\_\_
3. Neighboring Structures \_\_\_\_\_  
 Style: Colonial Federal Greek Revival Gothic Revival Italian Villa Lombard Rom.  
 Venetian Gothic Mansard Richardsonian Modern \_\_\_\_\_

Use: Residential Commercial Religious \_\_\_\_\_ Conditions: Excellent Good Fair Deteriorated \_\_\_\_\_

GIVE A BRIEF DESCRIPTION OF HISTORIC IMPORTANCE OF SITE (Refer and elaborate on theme circled on front of form)

*The Old Poor Farm*

*Owner says house about 200 yrs old.*

## BIBLIOGRAPHY AND/OR REFERENCE

*1870 - Dorr*

Where	Other
Language	Medium
Collection	Religion/Bibliography
Education	Military Affairs
Art/Architecture	Travel/Communication
Art/Architecture	Science/Invention
Geography	Commerce/Industry

Following names: (see also reverse side)  
 Building has historical connection with the

Source of data \_\_\_\_\_  
 Date \_\_\_\_\_  
 Open to public \_\_\_\_\_  
 Present owner \_\_\_\_\_  
 Use: original & present \_\_\_\_\_

## RESTRICTIONS

Original Owner: \_\_\_\_\_  
 Deed Information: Book Number \_\_\_\_\_ Page \_\_\_\_\_, \_\_\_\_\_ Registry of Deeds \_\_\_\_\_