

Massachusetts Cultural Resource Information System

Scanned Record Cover Page

Inventory No:	SBR.170
Historic Name:	
Common Name:	
Address:	95 Southville Rd
City/Town:	Southborough
Village/Neighborhood:	Cordaville
Local No:	277-3-25
Year Constructed:	r 1865
Architect(s):	
Architectural Style(s):	Federal
Use(s):	Single Family Dwelling House
Significance:	Architecture
Area(s):	SBR.C: Cordaville
Designation(s):	
Building Materials(s):	Roof: Slate Wall: Aluminum Siding; Wood Foundation: Granite; Stone, Cut; Concrete Unspecified



The Massachusetts Historical Commission (MHC) has converted this paper record to digital format as part of ongoing projects to scan records of the Inventory of Historic Assets of the Commonwealth and National Register of Historic Places nominations for Massachusetts. Efforts are ongoing and not all inventory or National Register records related to this resource may be available in digital format at this time.

The MACRIS database and scanned files are highly dynamic; new information is added daily and both database records and related scanned files may be updated as new information is incorporated into MHC files. Users should note that there may be a considerable lag time between the receipt of new or updated records by MHC and the appearance of related information in MACRIS. Users should also note that not all source materials for the MACRIS database are made available as scanned images. Users may consult the records, files and maps available in MHC's public research area at its offices at the State Archives Building, 220 Morrissey Boulevard, Boston, open M-F, 9-5.

Users of this digital material acknowledge that they have read and understood the MACRIS Information and Disclaimer (<http://mhc-macris.net/macrisdisclaimer.htm>)

Data available via the MACRIS web interface, and associated scanned files are for information purposes only. THE ACT OF CHECKING THIS DATABASE AND ASSOCIATED SCANNED FILES DOES NOT SUBSTITUTE FOR COMPLIANCE WITH APPLICABLE LOCAL, STATE OR FEDERAL LAWS AND REGULATIONS. IF YOU ARE REPRESENTING A DEVELOPER AND/OR A PROPOSED PROJECT THAT WILL REQUIRE A PERMIT, LICENSE OR FUNDING FROM ANY STATE OR FEDERAL AGENCY YOU MUST SUBMIT A PROJECT NOTIFICATION FORM TO MHC FOR MHC'S REVIEW AND COMMENT. You can obtain a copy of a PNF through the MHC web site (www.sec.state.ma.us/mhc) under the subject heading "MHC Forms."

Commonwealth of Massachusetts
Massachusetts Historical Commission
220 Morrissey Boulevard, Boston, Massachusetts 02125
www.sec.state.ma.us/mhc

This file was accessed on:

Saturday, July 09, 2016 at 2:34: PM

FORM B - BUILDING

Assessor's Number

USGS Quad

Area(s)

Form Number

Massachusetts Historical Commission

277/3/25

Marlborough

170



nearest cross streets and/or major natural features. Show all buildings between inventoried building and nearest intersection or natural feature. Label streets including route numbers, if any. Circle and number the inventoried building. Indicate north.

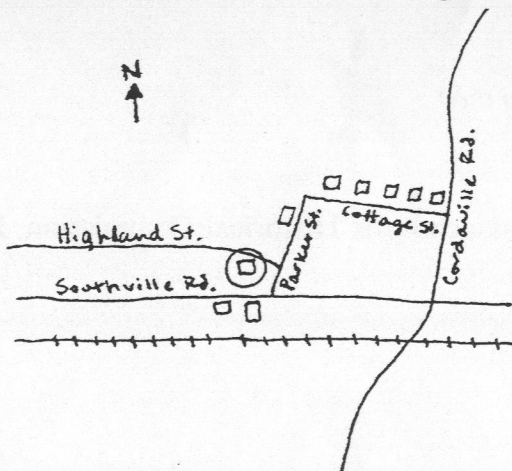

Recorded by Barbara Putnam and Rachel Smith

Organization Timelines, Inc.

Date (month/year) 1/95

Town Southborough

Place (neighborhood or village) Pl. Corda

Cordaville

Address 95 Southville Road

Historic Name _____

Uses: Present Residence

Original Residence

Date of Construction ca. 1810

Source Town Assessor's Office

Style/Form _____

Architect/Builder _____

Exterior Material:

Foundation Granite

Wall/Trim Aluminum siding

Roof Slate

Outbuildings/Secondary Structures _____

Major Alterations (with dates) _____

Condition Fair

Moved ☐ no ☐ yes Date _____

Acreage .65 acres

Setting North of the Boston and

Worcester Railroad, in a residential

area.

BUILDING FORM

ARCHITECTURAL DESCRIPTION ☐ *see continuation sheet*

Describe architectural features. Evaluate the characteristics of this building in terms of other buildings within the community.

Rising from a granite foundation, 95 Southville Road is a rectangular two-and-a-half-story, side-gable residence. The building is wood frame and the exterior material is now aluminum siding. The building is three bays deep and the windows have been replaced. The entrance on the facade is original with sidelights. An L addition with a concrete foundation lies on the south side and a shed-roofed addition and garage are on the north side; both are aluminum sided. The gable roof is of slate shingle. 95 Southville Road is a less common example of Georgian architecture.

HISTORICAL NARRATIVE ☐ *see continuation sheet*

Discuss the history of the building. Explain its associations with local (or state) history. Include uses of the buildings, and the role(s) the owners/occupants played within the community.

95 Southville Road was constructed during the Federal Period (1775-1830), when Southborough was an agricultural community, with industries making boots and shoes, straw hats, and palm-leaf hats making their appearance during this time period. The Boston and Worcester Turnpike was constructed in 1810 in Southborough and the Boston-Worcester Railroad was constructed in 1835. 95 Southville Road was built ca. 1810 and is one of the earliest remaining structures along Southville Road in Cordaville and Southville.

BIBLIOGRAPHY and/or REFERENCES ☐ *see continuation sheet*

Massachusetts Historical Commission

1983 *Reconnaissance Survey Report: Southborough*. Massachusetts Historical Commission, Boston.

☐ Recommended for listing in the National Register of Historic Places. *If checked, you must attach a completed National Register Criteria Statement Form.*

(Attach photo here)

C
Southborough

et address 95 Southville Rd.

e

: original & present

esent owner Hoisington

en to public no

e Style

rce of date

Development of town/city
Architectural reason for inventorying:

Pre 1870

Architect

OR part of Area #

3. CONDITION Excellent Good Fair Deteriorated Moved Altered Added

4. DESCRIPTION

FOUNDATION/BASEMENT: High Regular Low Material Granite (from Southville Quarry)

WALL COVER: Wood clapboard Brick Stone Other

ROOF: Ridge Gambrel Flat Hip Mansard
Tower Cupola Dormer windows Balustrade Grillwork

CHIMNEYS: 1 2 3 4 Center End Interior Irregular Cluster Elaborate

STORIES: 1 2 3 4 ATTACHMENTS: Wings Ell Shed Garage

PORCHES: 1 2 3 4 Entry PORTICO Balcony

FACADE: Gable end: Front/side Ornament

Entrance: Side Front: Center/Side Details: Sidelight

Windows: Spacing: Regular Irregular Identical/Varied 6/6

Corners: Plain Pilasters Quoins Cornerboards

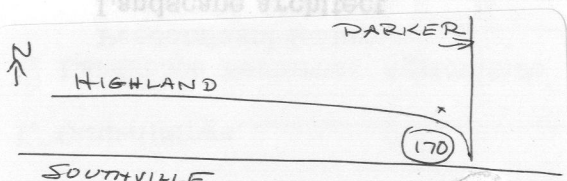
5. Indicate location of building in relation to
nearest cross streets and other buildings6. Footage of structure from street
Property has feet frontage on street

Recorder

For

Photo # 1071 5-14 Date

SEE REVERSE SIDE

RELATION OF SURROUNDING STRUCTURE

1. Outbuildings _____
2. Landscape Features: Agriculture Open Wooded Garden: Formal/Informal
 Predominant features _____
 Landscape architect _____
3. Neighboring Structures
 Style: Colonial Federal Greek Revival Gothic Revival Italian Villa Lombard Rom.
 Venetian Gothic Mansard Richardsonian Modern

Use: Residential Commercial Religious Conditions: Excellent Good Fair Deteriorated

GIVE A BRIEF DESCRIPTION OF HISTORIC IMPORTANCE OF SITE (Refer and elaborate on theme circled on front of form)

Kitchen has original dutch oven. Three other fireplaces. All original doors

DESCRIPTION

3. CONDITION Excellent Good Fair Deteriorated Moved Vandalized Vandalized

BIBLIOGRAPHY AND/OR REFERENCE

1870 Atlas Cordaville Wooden Mill

1898

1. *1870 Atlas*
 2. *1898*
 3. *1898*
 4. *1898*
 5. *1898*
 6. *1898*
 7. *1898*
 8. *1898*
 9. *1898*
 10. *1898*

Source of data

Date Date

Open to public

Present owner

Use: original & present

RESTRICTIONS

Original Owner: _____
 Deed Information: Book Number _____ Page _____, _____ Registry of Deeds