

Massachusetts Cultural Resource Information System

Scanned Record Cover Page

Inventory No:	SBR.171
Historic Name:	Southborough Jail
Common Name:	Cordaville Woolen Mill Company Store
Address:	91 Southville Rd
City/Town:	Southborough
Village/Neighborhood:	Cordaville
Local No:	
Year Constructed:	r 1880
Architect(s):	
Architectural Style(s):	No style
Use(s):	General Retail Store; Penal Institution; Single Family Dwelling House
Significance:	Architecture; Commerce; Industry; Law; Politics Government
Area(s):	SBR.C: Cordaville
Designation(s):	
Building Materials(s):	Roof: Asphalt Shingle Wall: Brick; Wood; Wood Clapboard Foundation: Brick; Granite; Stone, Cut



The Massachusetts Historical Commission (MHC) has converted this paper record to digital format as part of ongoing projects to scan records of the Inventory of Historic Assets of the Commonwealth and National Register of Historic Places nominations for Massachusetts. Efforts are ongoing and not all inventory or National Register records related to this resource may be available in digital format at this time.

The MACRIS database and scanned files are highly dynamic; new information is added daily and both database records and related scanned files may be updated as new information is incorporated into MHC files. Users should note that there may be a considerable lag time between the receipt of new or updated records by MHC and the appearance of related information in MACRIS. Users should also note that not all source materials for the MACRIS database are made available as scanned images. Users may consult the records, files and maps available in MHC's public research area at its offices at the State Archives Building, 220 Morrissey Boulevard, Boston, open M-F, 9-5.

Users of this digital material acknowledge that they have read and understood the MACRIS Information and Disclaimer (<http://mhc-macris.net/macrisdisclaimer.htm>)

Data available via the MACRIS web interface, and associated scanned files are for information purposes only. THE ACT OF CHECKING THIS DATABASE AND ASSOCIATED SCANNED FILES DOES NOT SUBSTITUTE FOR COMPLIANCE WITH APPLICABLE LOCAL, STATE OR FEDERAL LAWS AND REGULATIONS. IF YOU ARE REPRESENTING A DEVELOPER AND/OR A PROPOSED PROJECT THAT WILL REQUIRE A PERMIT, LICENSE OR FUNDING FROM ANY STATE OR FEDERAL AGENCY YOU MUST SUBMIT A PROJECT NOTIFICATION FORM TO MHC FOR MHC'S REVIEW AND COMMENT. You can obtain a copy of a PNF through the MHC web site (www.sec.state.ma.us/mhc) under the subject heading "MHC Forms."

Commonwealth of Massachusetts
Massachusetts Historical Commission
220 Morrissey Boulevard, Boston, Massachusetts 02125
www.sec.state.ma.us/mhc

This file was accessed on:

Saturday, July 09, 2016 at 2:33: PM



Pl. CORN 171 L
C
Southborough
address 91 Southville Rd
original & present Fair / dwelling
ent owner Curtis MacLaughlin
to public
Style

Literature Indians Source of date
Music Other
Development of town/city Architect
Architectural reason for inventorying: Pre 1870
OR part of Area #
3. CONDITION Excellent Good Fair Deteriorated Moved Altered Added

4. DESCRIPTION

FOUNDATION/BASEMENT: High Regular Low Material Brick - granite from the quarry
WALL COVER: Wood Brick Stone Other
ROOF: Ridge Gambrel Flat Hip Mansard
Tower Cupola Dormer windows Balustrade Grillwork
CHIMNEYS: 1 2 3 4 Center End Interior Irregular Cluster Elaborate
STORIES: 1 2 3 4 ATTACHMENTS: Wings Ell Shed added in 1900's
PORCHES: 1 2 3 4 Side PORTICO Balcony
FACADE: Gable end: Front/side Ornament
Entrance: Side Front: Center/Side Details:
Windows: Spacing: Regular/Irregular Identical/Varied
Corners: Plain Pilasters Quoins Cornerboards

5. Indicate location of building in relation to nearest cross streets and other buildings

6. Footage of structure from street
Property has feet frontage on street

Recorder

For

Photo # 5-15 Date 1971

SEE REVERSE SIDE

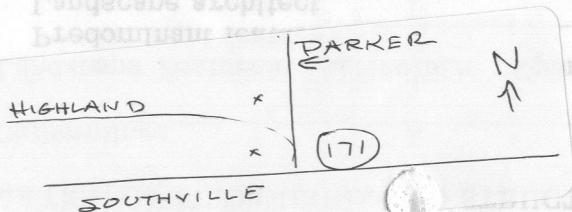

RELATION OF SURROUNDING STRUCTURE

SBR.171

1. Outbuildings _____
2. Landscape Features: Agriculture Open Wooded Garden: Formal/Informal
 Predominant features _____
 Landscape architect _____

3. Neighboring Structures
 Style: Colonial Federal Greek Revival Gothic Revival Italian Villa Lombard Rom.
 Venetian Gothic Mansard Richardsonian Modern _____
 Use: Residential Commercial Religious Conditions: Excellent Good Fair Deteriorated

GIVE A BRIEF DESCRIPTION OF HISTORIC IMPORTANCE OF SITE (Refer and elaborate on theme circled on front of form)

*On the Jacqueline Jones added
 system.
 Also a store for the blanket mill*

BIBLIOGRAPHY AND/OR REFERENCE

1870 Atlas - Old Jail

RESTRICTIONS

Original Owner: _____
 Deed Information: Book Number _____ Page _____, _____ Registry of Deeds