

Massachusetts Cultural Resource Information System

Scanned Record Cover Page

| | |
|--------------------------------|---|
| Inventory No: | SBR.314 |
| Historic Name: | Staples, Frederic House |
| Common Name: | Saxonville Baptist Church - Chapel of the Cross |
| Address: | 9 Cordaville Rd |
| City/Town: | Southborough |
| Village/Neighborhood: | Southborough |
| Local No: | 54-21 |
| Year Constructed: | c 1915 |
| Architect(s): | |
| Architectural Style(s): | Colonial Revival |
| Use(s): | Chapel; Church; Single Family Dwelling House |
| Significance: | Architecture; Religion |
| Area(s): | |
| Designation(s): | |
| Building Materials(s): | Roof: Asphalt Shingle Wall: Wood Shingle; Wood; Vinyl Siding Foundation: Stone, Uncut; Concrete Unspecified |



The Massachusetts Historical Commission (MHC) has converted this paper record to digital format as part of ongoing projects to scan records of the Inventory of Historic Assets of the Commonwealth and National Register of Historic Places nominations for Massachusetts. Efforts are ongoing and not all inventory or National Register records related to this resource may be available in digital format at this time.

The MACRIS database and scanned files are highly dynamic; new information is added daily and both database records and related scanned files may be updated as new information is incorporated into MHC files. Users should note that there may be a considerable lag time between the receipt of new or updated records by MHC and the appearance of related information in MACRIS. Users should also note that not all source materials for the MACRIS database are made available as scanned images. Users may consult the records, files and maps available in MHC's public research area at its offices at the State Archives Building, 220 Morrissey Boulevard, Boston, open M-F, 9-5.

Users of this digital material acknowledge that they have read and understood the MACRIS Information and Disclaimer (<http://mhc-macris.net/macrisdisclaimer.htm>)

Data available via the MACRIS web interface, and associated scanned files are for information purposes only. THE ACT OF CHECKING THIS DATABASE AND ASSOCIATED SCANNED FILES DOES NOT SUBSTITUTE FOR COMPLIANCE WITH APPLICABLE LOCAL, STATE OR FEDERAL LAWS AND REGULATIONS. IF YOU ARE REPRESENTING A DEVELOPER AND/OR A PROPOSED PROJECT THAT WILL REQUIRE A PERMIT, LICENSE OR FUNDING FROM ANY STATE OR FEDERAL AGENCY YOU MUST SUBMIT A PROJECT NOTIFICATION FORM TO MHC FOR MHC'S REVIEW AND COMMENT. You can obtain a copy of a PNF through the MHC web site (www.sec.state.ma.us/mhc) under the subject heading "MHC Forms."

Commonwealth of Massachusetts
Massachusetts Historical Commission
220 Morrissey Boulevard, Boston, Massachusetts 02125
www.sec.state.ma.us/mhc

This file was accessed on:

Thursday, July 07, 2016 at 5:39: PM

FORM B - BUILDING

Assessor's number

USGS Quad

Area(s)

Form Number

Massachusetts Historical Commission

54-21

Marlborough

314, 315

Massachusetts Archives Building

220 Morrissey Boulevard

Boston, MA 02125

RECEIVED

JUL 03 2000

MASS. HIST. COMM

Town Southborough

Place (neighborhood or village) _____

Southborough centerAddress 9 Cordaville RoadHistoric Name Staples House; Chapel of the CrossPresent churchOriginal dwellingDate of Construction 1915-16Assessment Noble; visual assessmentStyle/Form Colonial RevivalArchitect/Builder unknown

Exterior Material:

Foundation parged over rubbleSiding/Trim wood shakesRoof asphalt

Outbuildings/Secondary Structures _____

hip-roofed garage, ca. 1915-20; 4-bay shedMajor Alterations (with dates) mid-1990s:large chapel addition on south endCondition goodMoved ☒ no ☐ yes Date N/AAcreage 1.7 acresSetting Opposite Choate Field/Woodward Schoolin line of early-20th C. houses on large lots.Rural cemetery to south and rear.

Photograph

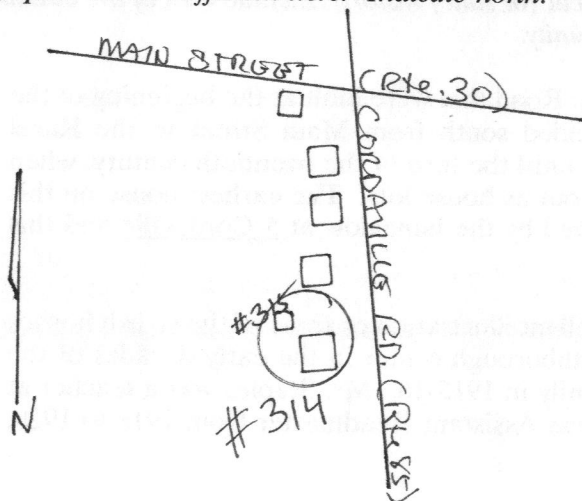

inventory forms have been completed. Label streets, including route numbers, if any. Attach a separate sheet if space is not sufficient here. Indicate north.

Recorded by Forbes/Schuler, consultantsOrganization Southborough Historical CommissionDate March, 2000

ARCHITECTURAL DESCRIPTION ☐ *see continuation sheet*

Describe architectural features. Evaluate the characteristics of this building in terms of other buildings within the community.

While still a large building, this 1915-16 house is a somewhat more modest house than the great riverfront Colonial Revival mansions built in the early twentieth century by members of Southborough's most elite families, such as the Choates, Burnetts, and Gardners. It is a long, two-story, five-bay, side-gabled house with a slightly higher two-bay wing at the south end, and a long cross-gabled rear wing. Five large painted chimneys animate the building's silhouette. Two are exterior--one at the north end of the main building and another at the west end of the rear wing--and three are interior--one at each juncture of the main house with the wings, and a third on the rear roof slope of the south wing.

The facade of the main house is arranged asymmetrically in six bays, with three bays of 12-over-12-sash windows at each story north of the entry bay, and two bays of the same type of windows at the south end. The facade windows have projecting, molded surrounds, and retain what appear to be their original wooden louvered shutters. On the front roof slope are three small gable-roofed dormers, each with a 6-over-6-sash window. The main entry is sheltered by a heavy, pedimented hood trimmed with small modillions and a pulvinated frieze, supported on simple diagonal braces. The facade of the south wing has one large tripartite 15/15 sash at the first story, trimmed with later shutters, and two 12/12's at the second. The trim of the main part of the house is typical of the early-twentieth-century Colonial Revival. A shallow dentiled and molded, boxed cornice above a bed molding trims the roofline of the main facade; there is no roof overhang at the gable end.

The north end of the house is dominated by the exterior chimney, and its only window is a 12-over-12-sash second-story window, located toward the rear. The north elevation of the rear wing is three bays long, with small 6-over-6-sash windows in projecting enframements. An entry door located in the center bay is sheltered by a gabled hood on square posts.

Although the house has been left intact, a large gable-front, vinyl-sided chapel, attached to the house by a gable-roofed, two-story section, was added at the south end in the mid-1990s.

This property retains a two-car, hip-roofed garage (#315) that dates to the same period as the house.

HISTORICAL NARRATIVE ☐ *see continuation sheet*

Explain history of the building. Explain its associations with local (or state) history. Include uses of the building, and the role(s) the owners/occupants played within the community.

This house is one of several on the upper part of Cordaville Road that were built at the beginning of the twentieth century on the portion of road that was extended south from Main Street to the Rural Cemetery in the 1840s. The road was lined with farmland until the turn of the twentieth century, when lots on the west side, north of the cemetery, were divided out as house lots. The earliest house on this section was 3 Cordaville Road, built in about 1900, followed by the bungalow at 5 Cordaville and this handsome Colonial Revival dwelling.

9 Cordaville Road, originally a private residence, is an excellent illustration of some of the stylish houses that were being built on some of the outer streets of Southborough center in the early decades of the twentieth century. It was built by the **Frederic Staples** family in 1915-16. Mr. Staples was a teacher at the Fay School, where he joined the faculty in 1899. He was Assistant Headmaster from 1918 to 1928, when he retired.

In 1987, a Baptist society relocated to Southborough from Saxonville in Framingham. Called at first the Saxonville Baptist Church, and later the Chapel of the Cross, the congregation worshipped first in various school buildings. In 1993 they purchased this house, and subsequently built the large chapel extension on the south end.

☐ Recommended for listing in the National Register of Historic Places. *If checked, a completed National Register Criteria Statement form is attached.*

INVENTORY FORM CONTINUATION SHEET

Community

Property

Southborough

9 Cordaville Road

Massachusetts Historical Commission
Massachusetts Archives Building
220 Morrissey Boulevard
Boston, Massachusetts 02125

Area(s)

Form No.
314, 315BIBLIOGRAPHY and/or REFERENCES [] *see continuation sheet*

The Marlborough Directory. Various dates and publishers.

Town of Southborough: Tax Valuations, various dates.

Information from local residents, June, 2000.

Noble, Richard. Fences of Stone: a History of Southborough, MA. Portsmouth, NH: Peter Randall, 1990.

Southborough Historical Society: photograph collection.