

Massachusetts Cultural Resource Information System

Scanned Record Cover Page

Inventory No:	SBR.234
Historic Name:	Watson, Rev. Woodman H. House
Common Name:	Howe, William W. House
Address:	88 Turnpike Rd
City/Town:	Southborough
Village/Neighborhood:	Fayville
Local No:	38-11
Year Constructed:	c 1867
Architect(s):	
Architectural Style(s):	Greek Revival
Use(s):	Agricultural; Multiple Family Dwelling House; Single Family Dwelling House
Significance:	Agriculture; Architecture
Area(s):	SBR.D: Fayville
Designation(s):	
Building Materials(s):	Roof: Asphalt Shingle Wall: Wood Clapboard; Wood; Wood Shake Foundation: Brick



The Massachusetts Historical Commission (MHC) has converted this paper record to digital format as part of ongoing projects to scan records of the Inventory of Historic Assets of the Commonwealth and National Register of Historic Places nominations for Massachusetts. Efforts are ongoing and not all inventory or National Register records related to this resource may be available in digital format at this time.

The MACRIS database and scanned files are highly dynamic; new information is added daily and both database records and related scanned files may be updated as new information is incorporated into MHC files. Users should note that there may be a considerable lag time between the receipt of new or updated records by MHC and the appearance of related information in MACRIS. Users should also note that not all source materials for the MACRIS database are made available as scanned images. Users may consult the records, files and maps available in MHC's public research area at its offices at the State Archives Building, 220 Morrissey Boulevard, Boston, open M-F, 9-5.

Users of this digital material acknowledge that they have read and understood the MACRIS Information and Disclaimer (<http://mhc-macris.net/macrisdisclaimer.htm>)

Data available via the MACRIS web interface, and associated scanned files are for information purposes only. THE ACT OF CHECKING THIS DATABASE AND ASSOCIATED SCANNED FILES DOES NOT SUBSTITUTE FOR COMPLIANCE WITH APPLICABLE LOCAL, STATE OR FEDERAL LAWS AND REGULATIONS. IF YOU ARE REPRESENTING A DEVELOPER AND/OR A PROPOSED PROJECT THAT WILL REQUIRE A PERMIT, LICENSE OR FUNDING FROM ANY STATE OR FEDERAL AGENCY YOU MUST SUBMIT A PROJECT NOTIFICATION FORM TO MHC FOR MHC'S REVIEW AND COMMENT. You can obtain a copy of a PNF through the MHC web site (www.sec.state.ma.us/mhc) under the subject heading "MHC Forms."

Commonwealth of Massachusetts
Massachusetts Historical Commission
220 Morrissey Boulevard, Boston, Massachusetts 02125
www.sec.state.ma.us/mhc

This file was accessed on:

Saturday, July 09, 2016 at 5:25: PM

Massachusetts Historical Commission
Massachusetts Archives Building
220 Morrissey Boulevard
Boston, MA 02125

38-11

Marlborough

D

234

Town Southborough

Place (neighborhood or village) _____

FayvilleAddress 88 Turnpike RoadHistoric Name Rev. Woodman Watson HouseUses: Present two-family dwellingOriginal dwellingDate of Construction ca. 1867-68Source deeds; maps; visual assessmentStyle/Form Greek RevivalArchitect/Builder unknown

Exterior Material:

Foundation parged (apparently brick)Wall/Trim wood clapboard; wood shakes
on rear of wingRoof asphalt

Outbuildings/Secondary Structures _____

none

Major Alterations (with dates) _____

rear wing altered (see text)Condition goodMoved ☒ no ☐ yes Date N/AAcreage .37 acresSetting Located on overgrown, formerly

rural lot on short section of Rte 9 where a
handful of older dwelling houses remains.
Opposite young woods at corner of Woodland.



Sketch Map

Draw a map of the area indicating properties within it. Number each property for which individual inventory forms have been completed. Label streets, including route numbers, if any. Attach a separate sheet if space is not sufficient here. Indicate north.

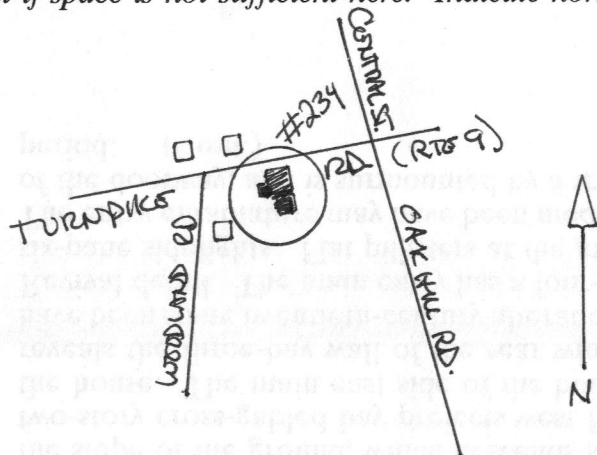
Recorded by Anne Forbes, consultantOrganization Southborough Historical Comm.Date JUL 08 1999 June, 1999

BUILDING FORM

ARCHITECTURAL DESCRIPTION ☒ *see continuation sheet*

Describe architectural features. Evaluate the characteristics of this building in terms of other buildings within the community.

This is one of few nineteenth-century gable-front, side-hall-entry houses remaining on the Southborough section of Route 9, the former Boston & Worcester Turnpike. It is 2 1/2-stories, and has a two-story rear wing with a roof of uneven pitch and a high basement story built into the slope of the ground, which descends sharply to the south away from the road. A shallow two-story cross-gabled bay projects west from the southwest rear portion of the main part of the house. The main east side of the building is four bays long; the view of it from the east reveals the three-bay wall of the rear wing, with its own enclosed entrance. Although there have been some twentieth-century alterations, the building retains much of its vernacular Greek Revival detail. The main entry has a four-paneled door with applied moldings, and full-length six-pane sidelights. Flat pilasters at the main doorway have both plinths and molded capitals. The entry entablature may have been modified, however, as the frieze is narrower than the rest of the doorway, and is surmounted by a triangular pediment of a type that is not typical of the period. (Cont.)

HISTORICAL NARRATIVE ☐ *see continuation sheet*

Explain history of the building. Explain its associations with local (or state) history. Include uses of the building, and the role(s) the owners/occupants played within the community.

Although the exact origin of this house is uncertain, its form and style, which are consistent with the Civil War period, suggest that it was built either by or for the **Rev. Woodman H. Watson**, pastor of the Fayville Baptist Church from 1866 to 1868. Before the Rev. Watson's arrival, the church, (which in 1845 replaced an earlier, smaller church, and stood just across the Turnpike until 1915), had undergone a period of bitter conflict among its congregation. The disagreement centered on the policies of its former minister, the Rev. Austin Robbins, who had been forced to resign. So bitter was the dispute that it split the congregation between the Rev. Robbins' supporters and opponents, and in 1865 it was agreed to close the church for a full year. The Rev. Watson was the first minister to take the pulpit after the church reopened in 1866. He, too, may have had a difficult pastorate, as he resigned after only two years.

Rev. Watson apparently left the ministry altogether, as he remained here, increasing the size of the parcel to several acres and probably doing some small-scale farming, until his death in about 1893. After a brief period under the ownership of his heirs, the property was sold to **William W. Howe** in 1895. He owned the house until at least 1915.

BIBLIOGRAPHY and/or REFERENCES ☐ *see continuation sheet*

Maps and Atlases: 1870: WH Watson; 1898: WW Howe.
The Marlborough Directory. Various dates and publishers.
 Noble, Richard. Fences of Stone: a History of Southborough, MA. Portsmouth, NH: Peter Randall, 1990.
 Town of Southborough: Assessor's Reports, various dates.
 Worcester County Registry of Deeds: 1293/418.

☐ Recommended for listing in the National Register of Historic Places. *If checked, a completed-National Register Criteria Statement form is attached.*

Southborough W.H. Watson House

Massachusetts Historical Commission
Massachusetts Archives Building
220 Morrissey Boulevard
Boston, Massachusetts 02125

Area(s)
D

Form No.
234

ARCHITECTURAL DESCRIPTION, cont.

The house trim includes wide, flat corner pilasters with molded caps, a wide frieze, and an overhanging, molded, boxed cornice with an echinus crown molding and a bed molding at the top of the frieze. A simple water table trims the top of the foundation. Most of the windows are late-nineteenth-century 2-over-2-sash with flat surrounds. The windows of the rear wing, however, are 6-over-6-sash, and the windows of the west bay have projecting, dentiled crowns and molded surrounds. (Marks on the west wall of the bay indicate that at least two of the window crowns have been removed).

A barn is shown close to the southeast rear corner of the building on the map of 1898. This property stood in the path of the devastating tornado that ripped through the southeast part of Southborough in June of 1953, killing three people in Fayville, injuring seventy-five, and destroying several buildings. The barn may have been lost at that time, and the odd appearance of the rear wing, with its unevenly-pitched roof and different types of siding, may have resulted from some tornado damage.





P. FAY
234
D
Southborough
address 88 Turnpike Rd
original & present dwelling
ent owner Swartwood
to public
Style

Literature Indians
Music Other
Development of town/city
Architectural reason for inventorying: Architect

OR part of Area #
3. CONDITION Excellent Good Fair Deteriorated Moved Altered Added 2 apartments

4. DESCRIPTION

FOUNDATION/BASEMENT: High Regular Low Material Brick
WALL COVER: Wood Clapboard Brick Stone Other
ROOF: Ridge Gambrel Flat Hip Mansard
Tower Cupola Dormer windows Balustrade Grillwork
CHIMNEYS: 1 2 3 4 Center End Interior Irregular Cluster Elaborate
STORIES: 1 2 3 4 ATTACHMENTS: Wings Ell Shed
PORCHES: 1 2 3 4 PORTICO Balcony
FACADE: Gable end: Front/side Ornament
Entrance: Side Front: Center/Side Details:
Windows: Spacing: Regular Irregular Identical/Varied
Corners: Plain Pilasters Quoins Cornerboards

5. Indicate location of building in relation to nearest cross streets and other buildings

6. Footage of structure from street
Property has feet frontage on street

Recorder

For

Photo # 7-13 Date 1971

SEE REVERSE SIDE

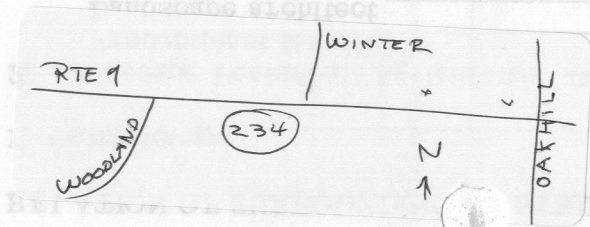

RELATION OF SURROUNDING STRUCTURE

SBR.234

1. Outbuildings _____
2. Landscape Features: Agriculture Open Wooded Garden: Formal/Informal
Predominant features _____
Landscape architect _____
3. Neighboring Structures
Style: Colonial Federal Greek Revival Gothic Revival Italian Villa Lombard Rom.
Venetian Gothic Mansard Richardsonian Modern
- Use: Residential Commercial Religious Conditions: Excellent Good Fair Deteriorated
-

GIVE A BRIEF DESCRIPTION OF HISTORIC IMPORTANCE OF SITE (Refer and elaborate on theme circled on front of form)

BIBLIOGRAPHY AND/OR REFERENCE

1898 Atlas - W.W. Howe

also

MacMay

RESTRICTIONS

Original Owner: _____
Deed Information: Book Number _____ Page _____, _____ Registry of Deeds