

# Massachusetts Cultural Resource Information System

## Scanned Record Cover Page

<b>Inventory No:</b>	SBR.160
<b>Historic Name:</b>	O'Brien House
<b>Common Name:</b>	Faber - Cummings House
<b>Address:</b>	6 Pearl St
<b>City/Town:</b>	Southborough
<b>Village/Neighborhood:</b>	Southville
<b>Local No:</b>	2-14
<b>Year Constructed:</b>	c 1860
<b>Architect(s):</b>	
<b>Architectural Style(s):</b>	No style
<b>Use(s):</b>	Single Family Dwelling House
<b>Significance:</b>	Architecture
<b>Area(s):</b>	SBR.B: Southville
<b>Designation(s):</b>	
<b>Building Materials(s):</b>	Roof: Asphalt Shingle Wall: Wood Clapboard; Wood



The Massachusetts Historical Commission (MHC) has converted this paper record to digital format as part of ongoing projects to scan records of the Inventory of Historic Assets of the Commonwealth and National Register of Historic Places nominations for Massachusetts. Efforts are ongoing and not all inventory or National Register records related to this resource may be available in digital format at this time.

The MACRIS database and scanned files are highly dynamic; new information is added daily and both database records and related scanned files may be updated as new information is incorporated into MHC files. Users should note that there may be a considerable lag time between the receipt of new or updated records by MHC and the appearance of related information in MACRIS. Users should also note that not all source materials for the MACRIS database are made available as scanned images. Users may consult the records, files and maps available in MHC's public research area at its offices at the State Archives Building, 220 Morrissey Boulevard, Boston, open M-F, 9-5.

Users of this digital material acknowledge that they have read and understood the MACRIS Information and Disclaimer (<http://mhc-macris.net/macrisdisclaimer.htm>)

Data available via the MACRIS web interface, and associated scanned files are for information purposes only. THE ACT OF CHECKING THIS DATABASE AND ASSOCIATED SCANNED FILES DOES NOT SUBSTITUTE FOR COMPLIANCE WITH APPLICABLE LOCAL, STATE OR FEDERAL LAWS AND REGULATIONS. IF YOU ARE REPRESENTING A DEVELOPER AND/OR A PROPOSED PROJECT THAT WILL REQUIRE A PERMIT, LICENSE OR FUNDING FROM ANY STATE OR FEDERAL AGENCY YOU MUST SUBMIT A PROJECT NOTIFICATION FORM TO MHC FOR MHC'S REVIEW AND COMMENT. You can obtain a copy of a PNF through the MHC web site ([www.sec.state.ma.us/mhc](http://www.sec.state.ma.us/mhc)) under the subject heading "MHC Forms."

Commonwealth of Massachusetts  
Massachusetts Historical Commission  
220 Morrissey Boulevard, Boston, Massachusetts 02125  
[www.sec.state.ma.us/mhc](http://www.sec.state.ma.us/mhc)

This file was accessed on:

Saturday, July 09, 2016 at 2:00: PM



PL S'ville 160  
B

2. Town Southborough  
Street address 6 Pearl St.  
Name \_\_\_\_\_  
Use: original & present dwelling  
Present owner Hitchcock  
Open to public \_\_\_\_\_  
Date \_\_\_\_\_ Style C1860  
Source of date \_\_\_\_\_  
Architect \_\_\_\_\_  
\_\_\_\_\_ OR part of Area # \_\_\_\_\_

3. CONDITION Excellent Good Fair Deteriorated Moved Altered Added \_\_\_\_\_

#### 4. DESCRIPTION

FOUNDATION/BASEMENT: High Regular Low Material \_\_\_\_\_

WALL COVER: Wood Clapboards Brick Stone Other \_\_\_\_\_

ROOF: Ridge Gambrel Flat Hip Mansard \_\_\_\_\_  
Tower Cupola Dormer windows Balustrade Grillwork \_\_\_\_\_

CHIMNEYS: 1 2 3 4 Center End Interior Irregular Cluster Elaborate

STORIES: 1 2 3 4 ATTACHMENTS: Wings Ell Shed \_\_\_\_\_

PORCHES: 1 2 3 4 \_\_\_\_\_ PORTICO \_\_\_\_\_ Balcony

FACADE: Gable end: Front/side Ornament \_\_\_\_\_

Entrance: Side Front: Center/Side Details: \_\_\_\_\_

Windows: Spacing: Regular/Irregular Identical/Varied \_\_\_\_\_

Corners: Plain Pilasters Quoins Cornerboards \_\_\_\_\_

5. Indicate location of building in relation to nearest cross streets and other buildings

6. Footage of structure from street \_\_\_\_\_  
Property has \_\_\_\_\_ feet frontage on street

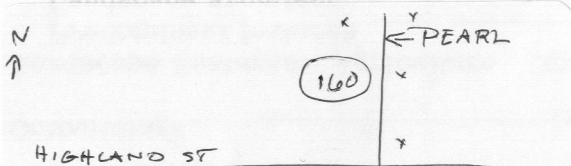

Recorder \_\_\_\_\_

For \_\_\_\_\_

Photo # 5-9 Date 1971

SEE REVERSE SIDE

## RELATION OF SURROUNDING STRUCTURE

1. Outbuildings \_\_\_\_\_
2. Landscape Features: Agriculture Open Wooded Garden: Formal/Informal  
 Predominant features \_\_\_\_\_  
 Landscape architect \_\_\_\_\_

## 3. Neighboring Structures

Style: Colonial Federal Greek Revival Gothic Revival Italian Villa Lombard Rom.  
 Venetian Gothic Mansard Richardsonian Modern

Use: Residential Commercial Religious Conditions: Excellent Good Fair Deteriorated

GIVE A BRIEF DESCRIPTION OF HISTORIC IMPORTANCE OF SITE (Refer and elaborate on theme circled on front of form)

BASCAGE: (circle) side

PORCHES: 1 3 3 4

STORIES: 1 3 3 4

CHIMNEYS: 1 3 3 4

BOOR: (circle) chimney

MATT COVER: wood

FOUNDATION/BASEMENT: high

## 4. DESCRIPTION

3. CONDITION Excellent Good Fair Deteriorated Moved Altered Vandal

## BIBLIOGRAPHY AND/OR REFERENCE

Also 1870 - O'Brien

" 1895 - "

Also

Faber

Lyon

Following themes: (see also related side)

Building has historical connection with the

1. Is the building historically significant to:

Office of the Secretary, State House, Boston

Original Owner: \_\_\_\_\_

Deed Information: Book Number \_\_\_\_\_ Page \_\_\_\_\_

Form B. 10M-11-69-045654

SOUTH BOROUGHS

Registry of Deeds