

Massachusetts Cultural Resource Information System

Scanned Record Cover Page

Inventory No:	SBR.304
Historic Name:	Baker, Frederick L. House
Common Name:	
Address:	6 Middle Rd
City/Town:	Southborough
Village/Neighborhood:	Southborough
Local No:	54-14
Year Constructed:	c 1900
Architect(s):	
Architectural Style(s):	No style
Use(s):	Single Family Dwelling House
Significance:	Architecture
Area(s):	
Designation(s):	
Building Materials(s):	Roof: Asphalt Shingle Wall: Asbestos Shingle; Wood Foundation: Stone, Uncut



The Massachusetts Historical Commission (MHC) has converted this paper record to digital format as part of ongoing projects to scan records of the Inventory of Historic Assets of the Commonwealth and National Register of Historic Places nominations for Massachusetts. Efforts are ongoing and not all inventory or National Register records related to this resource may be available in digital format at this time.

The MACRIS database and scanned files are highly dynamic; new information is added daily and both database records and related scanned files may be updated as new information is incorporated into MHC files. Users should note that there may be a considerable lag time between the receipt of new or updated records by MHC and the appearance of related information in MACRIS. Users should also note that not all source materials for the MACRIS database are made available as scanned images. Users may consult the records, files and maps available in MHC's public research area at its offices at the State Archives Building, 220 Morrissey Boulevard, Boston, open M-F, 9-5.

Users of this digital material acknowledge that they have read and understood the MACRIS Information and Disclaimer (<http://mhc-macris.net/macrisdisclaimer.htm>)

Data available via the MACRIS web interface, and associated scanned files are for information purposes only. THE ACT OF CHECKING THIS DATABASE AND ASSOCIATED SCANNED FILES DOES NOT SUBSTITUTE FOR COMPLIANCE WITH APPLICABLE LOCAL, STATE OR FEDERAL LAWS AND REGULATIONS. IF YOU ARE REPRESENTING A DEVELOPER AND/OR A PROPOSED PROJECT THAT WILL REQUIRE A PERMIT, LICENSE OR FUNDING FROM ANY STATE OR FEDERAL AGENCY YOU MUST SUBMIT A PROJECT NOTIFICATION FORM TO MHC FOR MHC'S REVIEW AND COMMENT. You can obtain a copy of a PNF through the MHC web site (www.sec.state.ma.us/mhc) under the subject heading "MHC Forms."

Commonwealth of Massachusetts
Massachusetts Historical Commission
220 Morrissey Boulevard, Boston, Massachusetts 02125
www.sec.state.ma.us/mhc

This file was accessed on:

Saturday, July 09, 2016 at 12:51 PM

FORM B - BUILDING

Assessor's number

USGS Quad

Area(s)

Form Number

Massachusetts Historical Commission
 Massachusetts Archives Building
 220 Morrissey Boulevard
 Boston, MA 02125

54-14

Marlborough

304, 305

Town Southborough

Place (neighborhood or village) _____

Southborough centerAddress 6 Middle RoadHistoric Name Frederick L. Baker HouseUses: Present dwellingOriginal dwellingDate of Construction ca. 1900Source visual assessmentType/Form 2 1/2-story gable-front houseArchitect/Builder unknown

Exterior Material:

Foundation rubbleWall/Trim asbestos sidingRoof asphaltOutbuildings/Secondary Structures 2-car

concrete-block gable-front garage with clapboarded gable, overhead panel-and-glass doors. Exposed rafter ends: early-20th C. (#304)

Major Alterations (with dates) Some window replacement--20th C.; modern paneled shutters.

Condition goodMoved [x] no [] yes Date N/AAcreage less than one acre

Setting Near upper end of Middle Road, in line of gable-front, mid-19th- to early-20th-C. houses.

Close to street on small lot.

Sketch Map

Draw a map of the area indicating properties within it. Number each property for which individual inventory forms have been completed. Label streets, including route numbers, if any. Attach a separate sheet if space is not sufficient here. Indicate north.

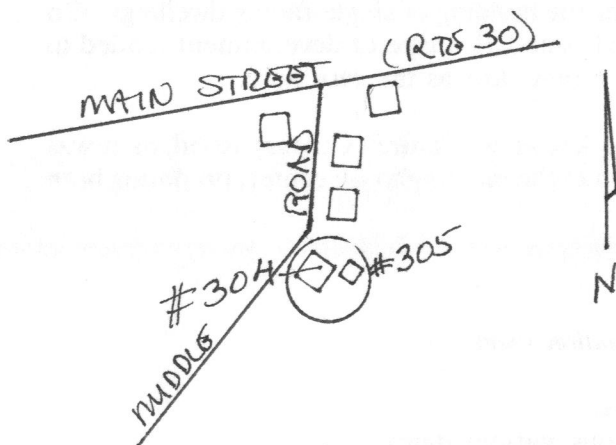
Recorded by Forbes/Schuler, consultantsOrganization Southborough Historical CommissionDate JUL 03 2000
February, 2000

MASS. HIST. COMM

ARCHITECTURAL DESCRIPTION ☐ *see continuation sheet*

Describe architectural features. Evaluate the characteristics of this building in terms of other buildings within the community.

6 Middle Road is the first in line of a group of three tall 2 1/2-story, ca. 1900 gable-front houses of similar design that stand close to the road on small lots. This one is two- by two-bays, with a second story which slightly overlaps the first. The main decorative elements are the classically-derived molded, boxed cornice, with returns, and the facade-width, hip-roofed front porch which retains a turned post at the southwest corner of its screened-in south end. The glass-and-panel door of the slightly off-center main entry is a typical turn-of-the-century example, with a large square light in the upper section. A second entry on the north side of the house has a modern multi-light-and panel steel door under an aluminum hood. The windows appear to be replacement wooden 6-over-1-sash in unmolded surrounds. Three skylights have been added to the south roof slope.

HISTORICAL NARRATIVE ☐ *see continuation sheet*

Explain history of the building. Explain its associations with local (or state) history. Include uses of the building, and the role(s) the owners/occupants played within the community.

This house, along with the two to its south at 8 and 10 Middle Road, are indicative of some of the small-scale development that was being done just after the turn of the twentieth century by local residents on some of the former farmland at or close to Southborough center. Map evidence indicates that as late as 1898 the property on which the three houses stand was part of the land associated with the new house of Charles Fairbanks at 34 Main Street (see Form #271). At that time his land extended east and southeast to Cordaville Road (Rte 85) for quite some distance, and southwest behind two other Main Street houses to Middle Road. The Fairbanks property had about 300 feet of frontage on Middle Road, where these three houses were constructed a few years later.

The earliest known resident of 6 Middle Road, was **Frederick L. Baker**, who owned it by 1903. He was an engineer at the Fay School, probably involved with its early electrical and power plant.

6 Middle Road is thus an early example of a trend which continues today in this former agricultural community--the subdividing of farmland into house lots for the building of single-family dwellings. On roads at or near the center, where the farms were relatively small, this type of development tended to be limited to the building of only two or three houses at a time, as was the case here.

Until the turn of the twentieth century, Middle Road was known as Centre (Center) Road, as it was the primary route that cut north through the middle of town to the meetinghouse center, predating both Cordaville and Parkerville Roads.

BIBLIOGRAPHY and/or REFERENCES ☐ *see continuation sheet*

Southborough street directories. 1905, 1913.

The Marlborough Directory. Various dates and publishers.

Town of Southborough: Annual Reports and Tax Valuations, various dates.

Worcester County Registry of Deeds.

[x] Recommended for listing in the National Register of Historic Places. *If checked, a completed National Register Criteria Statement form is attached.*

Massachusetts Historical Commission
220 Morrissey Boulevard
Boston, Massachusetts 02125

Community
Southborough

Property Address
6 Middle Road

Area(s)

Form No(s).
304, 305

National Register of Historic Places Criteria Statement Form

Check all that apply:

☐ Individually eligible ☒ Eligible only in a historic district
☒ Contributing to a potential historic district ☐ Potential historic district

Criteria: ☒ A ☐ B ☒ C ☐ D

Criteria Considerations: ☐ A ☐ B ☐ C ☐ D ☐ E ☐ F ☐ G

Statement of Significance by Forbes/Schuler, Consultants

The criteria that are checked in the above sections must be justified here.

This house is eligible for the National Register as a contributing property in a district encompassing the historic residential and institutional meetinghouse center of the town. Under Criterion A, it is significant of the later residential development of the center south of Main Street opposite the meetinghouse and common at the turn of the century, when small landowners were beginning to break up the small farms which had existed there to build houses on small lots. It meets Criterion C as an example of the large side-hall-entry house type which was still being built by local carpenters and builders at the turn of the twentieth century.

The property retains integrity of location, design, workmanship, feeling, setting and association.