

Massachusetts Cultural Resource Information System

Scanned Record Cover Page

Inventory No: SBR.179
Historic Name: Cordaville Manufacturing Company Worker Housing
Common Name:
Address: 5 Cottage St
City/Town: Southborough
Village/Neighborhood: Cordaville
Local No: 277-3-20
Year Constructed: c 1845
Architect(s):
Architectural Style(s): No style
Use(s): Single Family Dwelling House; Workers Housing
Significance: Architecture; Industry
Area(s): SBR.C: Cordaville
Designation(s):
Building Materials(s): Roof: Asphalt Shingle
Wall: Aluminum Siding; Wood
Foundation: Concrete Unspecified; Stone, Uncut



The Massachusetts Historical Commission (MHC) has converted this paper record to digital format as part of ongoing projects to scan records of the Inventory of Historic Assets of the Commonwealth and National Register of Historic Places nominations for Massachusetts. Efforts are ongoing and not all inventory or National Register records related to this resource may be available in digital format at this time.

The MACRIS database and scanned files are highly dynamic; new information is added daily and both database records and related scanned files may be updated as new information is incorporated into MHC files. Users should note that there may be a considerable lag time between the receipt of new or updated records by MHC and the appearance of related information in MACRIS. Users should also note that not all source materials for the MACRIS database are made available as scanned images. Users may consult the records, files and maps available in MHC's public research area at its offices at the State Archives Building, 220 Morrissey Boulevard, Boston, open M-F, 9-5.

Users of this digital material acknowledge that they have read and understood the MACRIS Information and Disclaimer (<http://mhc-macris.net/macrisdisclaimer.htm>)

Data available via the MACRIS web interface, and associated scanned files are for information purposes only. THE ACT OF CHECKING THIS DATABASE AND ASSOCIATED SCANNED FILES DOES NOT SUBSTITUTE FOR COMPLIANCE WITH APPLICABLE LOCAL, STATE OR FEDERAL LAWS AND REGULATIONS. IF YOU ARE REPRESENTING A DEVELOPER AND/OR A PROPOSED PROJECT THAT WILL REQUIRE A PERMIT, LICENSE OR FUNDING FROM ANY STATE OR FEDERAL AGENCY YOU MUST SUBMIT A PROJECT NOTIFICATION FORM TO MHC FOR MHC'S REVIEW AND COMMENT. You can obtain a copy of a PNF through the MHC web site (www.sec.state.ma.us/mhc) under the subject heading "MHC Forms."

Commonwealth of Massachusetts
Massachusetts Historical Commission
220 Morrissey Boulevard, Boston, Massachusetts 02125
www.sec.state.ma.us/mhc

This file was accessed on:

Friday, July 08, 2016 at 12:19 PM

FORM B - BUILDING

Assessor's Number

USGS Quad

Area(s)

Form Number

Massachusetts Historical Commission
80 Boylston Street
Boston, Massachusetts 02116

277/3/20

Marlborough

C

1791



Town Southborough

Place (neighborhood or village) Pl. Cord

Cordaville

Address 5 Cottage Street

Historic Name _____

Uses: Present Residence

Original Residence

Date of Construction ca. 1860

Source Town Assessor's Office

Style/Form _____

Architect/Builder _____

Exterior Material:

Foundation Concrete

Wall/Trim Aluminum siding

Roof Asphalt shingle

Outbuildings/Secondary Structures _____

Major Alterations (with dates) _____

Condition Fair

Moved no yes Date _____

Acreage .15 acres

Setting In a residential area,

north of the Boston-Worcester

Railroad _____

of natural features. Label streets showing some numbers if any. Circle and number the inventoried building. Indicate north.

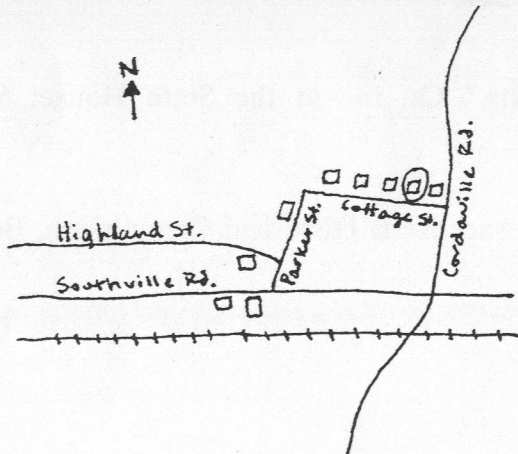

Recorded by Barbara Putnam and Rachel Smith

Organization Timelines, Inc.

Date (month/year) 1/95

BUILDING FORM

ARCHITECTURAL DESCRIPTION *see continuation sheet*

Describe architectural features. Evaluate the characteristics of this building in terms of other buildings within the community.

Rising from a concrete foundation, 5 Cottage Street is a two-story double rearward extension front gable residence. The building is wood-framed and aluminum siding has replaced the original wood exterior. The building is two bays deep. The facade of this building has a bay window extension with a hip roof. On the east, a hip roofed one-story addition is present and, to the west, a low-pitch gable extension. On the second story, gable dormers protrude from the asphalt shingle gable roof. One interior brick chimney and one metal pipe chimney on the east slope of the roof are present on this building. 5 Cottage Street is typical of its surroundings.

HISTORICAL NARRATIVE *see continuation sheet*

Discuss the history of the building. Explain its associations with local (or state) history. Include uses of the buildings, and the role(s) the owners/occupants played within the community.

5 Cottage Street was constructed during the Early Industrial Period (1830-1870), when Southborough's population increased as the Boston and Worcester Turnpike and the Boston-Worcester Railroad provided a means of transporting industry from Boston to more rural areas in Massachusetts. Agriculture remained a large portion of Southborough's economy, but industrial villages arose in Southville and Cordaville, resulting in the construction of residential buildings along Southville Road and Cottage Street to house the growing population of the town.

BIBLIOGRAPHY and/or REFERENCES *see continuation sheet*

Bailey, O. H.
 1887 Map of Southville and Cordaville, Massachusetts. On file at the State House: Special Collections.

Massachusetts Historical Commission
 1983 *Reconnaissance Survey Report: Southborough*. Massachusetts Historical Commission, Boston.

Recommended for listing in the National Register of Historic Places. *If checked, you must attach a completed National Register Criteria Statement Form.*



Pl. com
179

C

Southborough

Address 5 Cottage St.

Original & present Dwelling

owner David Egan

public

Style c. 1845

Literature _____ Indians _____ Source of date _____
 Music _____ Other _____
 Development of town/city _____ Architect _____
 Architectural reason for inventorying: _____

OR part of Area # _____

3. CONDITION Excellent Good Fair Deteriorated Moved Altered Added _____

4. DESCRIPTION

FOUNDATION/BASEMENT: High Regular Low Material Stone

WALL COVER: Wood Shingle Brick Stone Other _____

ROOF: Ridge Gambrel Flat Hip Mansard _____
 Tower Cupola Dormer windows Balustrade Grillwork _____

CHIMNEYS: 1 2 3 4 Center End Interior Irregular Cluster Elaborate

STORIES: 1 2 3 4 ATTACHMENTS: Wings Ell Shed

PORCHES: 1 2 3 4 _____ PORTICO _____ Balcony

FACADE: Gable end: Front side Ornament _____

Entrance: Side Front: Center Side Details: _____

Windows: Spacing: Regular Irregular Identical Varied

Corners: Plain Pilasters Quoins Cornerboards _____

5. Indicate location of building in relation to nearest cross streets and other buildings

6. Footage of structure from street _____
 Property has _____ feet frontage on street

Recorder _____

For _____

Photo # 5-36 Date 1971

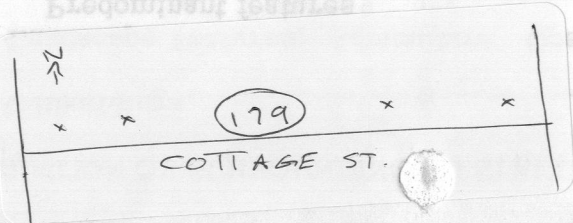

SEE REVERSE SIDE

RELATION OF SURROUNDING STRUCTURE

SBR.179

1. Outbuildings _____

2. Landscape Features: Agriculture Open Wooded Garden: Formal/Informal

Predominant features _____

Landscape architect _____

3. Neighboring Structures

Style: Colonial Federal Greek Revival Gothic Revival Italian Villa Lombard Rom.

Venetian Gothic Mansard Richardsonian Modern

Use: Residential Commercial Religious Conditions: Excellent Good Fair Deteriorated

GIVE A BRIEF DESCRIPTION OF HISTORIC IMPORTANCE OF SITE (Refer and elaborate on theme circled on front of form)

DESCRIPTION

BIBLIOGRAPHY AND/OR REFERENCE

1870 Atlas - Concordville Mfg.

Table with columns for Material, Object, Source of data, Date, Open to public, Present owner, Use: original & present, Name, Address.

RESTRICTIONS

Original Owner: _____ Deed Information: Book Number _____ Page _____, _____ Registry of Deeds