

# Massachusetts Cultural Resource Information System

## Scanned Record Cover Page

<b>Inventory No:</b>	SBR.38
<b>Historic Name:</b>	McMaster, H. House - Webster, Dr. House and Office
<b>Common Name:</b>	Fay School - Webster House
<b>Address:</b>	46 Main St
<b>City/Town:</b>	Southborough
<b>Village/Neighborhood:</b>	Southborough
<b>Local No:</b>	53-11; 19
<b>Year Constructed:</b>	c 1899
<b>Architect(s):</b>	
<b>Architectural Style(s):</b>	Queen Anne
<b>Use(s):</b>	Doctor Or Dentist Office; Other Residential; Single Family Dwelling House
<b>Significance:</b>	Architecture; Education; Health Medicine
<b>Area(s):</b>	SBR.AG: Southborough Town Center SBR.A: Main Street Area SBR.S: Fay School
<b>Designation(s):</b>	
<b>Building Materials(s):</b>	Roof: Asphalt Shingle Wall: Vinyl Siding; Wood Foundation: Brick



The Massachusetts Historical Commission (MHC) has converted this paper record to digital format as part of ongoing projects to scan records of the Inventory of Historic Assets of the Commonwealth and National Register of Historic Places nominations for Massachusetts. Efforts are ongoing and not all inventory or National Register records related to this resource may be available in digital format at this time.

The MACRIS database and scanned files are highly dynamic; new information is added daily and both database records and related scanned files may be updated as new information is incorporated into MHC files. Users should note that there may be a considerable lag time between the receipt of new or updated records by MHC and the appearance of related information in MACRIS. Users should also note that not all source materials for the MACRIS database are made available as scanned images. Users may consult the records, files and maps available in MHC's public research area at its offices at the State Archives Building, 220 Morrissey Boulevard, Boston, open M-F, 9-5.

Users of this digital material acknowledge that they have read and understood the MACRIS Information and Disclaimer (<http://mhc-macris.net/macrisdisclaimer.htm>)

Data available via the MACRIS web interface, and associated scanned files are for information purposes only. THE ACT OF CHECKING THIS DATABASE AND ASSOCIATED SCANNED FILES DOES NOT SUBSTITUTE FOR COMPLIANCE WITH APPLICABLE LOCAL, STATE OR FEDERAL LAWS AND REGULATIONS. IF YOU ARE REPRESENTING A DEVELOPER AND/OR A PROPOSED PROJECT THAT WILL REQUIRE A PERMIT, LICENSE OR FUNDING FROM ANY STATE OR FEDERAL AGENCY YOU MUST SUBMIT A PROJECT NOTIFICATION FORM TO MHC FOR MHC'S REVIEW AND COMMENT. You can obtain a copy of a PNF through the MHC web site ([www.sec.state.ma.us/mhc](http://www.sec.state.ma.us/mhc)) under the subject heading "MHC Forms."

Commonwealth of Massachusetts  
Massachusetts Historical Commission  
220 Morrissey Boulevard, Boston, Massachusetts 02125  
[www.sec.state.ma.us/mhc](http://www.sec.state.ma.us/mhc)

This file was accessed on:





ISI PTH 38  
A PL SWTH  
USW mail  
Southborough  
address 46 Main St.  
al use dwelling  
nt use  
nt owner Fay School  
o public  
Style Qn. Anne

Education Military affairs  
Government Religion/philosophy  
Literature Indians  
Music Development of town/city Architect

3. CONDITION: Excellent Good Fair Deteriorated Moved Altered Added

4. DESCRIPTION

FOUNDATION/BASEMENT: High Regular Low Material: Brick

WALL COVER: Wood Shingle Brick Stone Other

ROOF: Ridge Gambrel Flat Hip Mansard  
Tower Cupola Dormer windows Balustrade Grillwork

CHIMNEYS: 1 2 3 4 Center End Interior Irregular Cluster Elaborate

STORIES: 1 2 3 4 ATTACHMENTS: Wings Ell Shed

PORCHES: 1 2 3 4 PORTICO Balcony

FACADE: Gable end: Front/Side Ornament:

Entrance: Side Front: Center/Side Details:

Windows: Spacing: Regular Irregular Identical/Varied

Corners: Plain Pilasters Quoins Cornerboards

5. Indicate location of structure in relation to nearest cross streets and other buildings  
6. Footage of structure from street  
Property has feet frontage on street

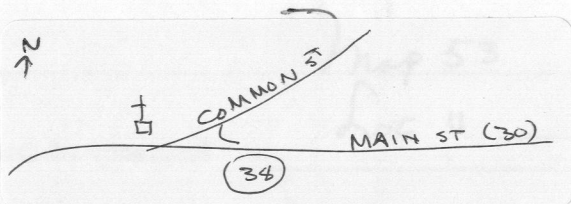

Recorder  
For  
Photo 2-1 Date 1971

SEE REVERSE SIDE

# RELATION OF SURROUNDING TO STRUCTURE

SBR.38

## 1. Outbuildings

## 2. Landscape Features: Agriculture Open Wooded Garden: Formal/Informal

Predominant features

Landscape architect

## 3. Neighboring Structures

Style: Colonial Federal Greek Revival Gothic Revival Italian Villa Lombard Rom.

Venetian Gothic Mansard Richardsonian Modern

Use: Residential Commercial Religious

Conditions: Excellent Good Fair Deteriorated

GIVE A BRIEF DESCRIPTION OF HISTORIC IMPORTANCE OF SITE (Refer and elaborate on theme circled on front of form)

Once the house of Dr. Webster who had his dentists office in the house. It has an unusual three-story round tower on the west end. ①

## BIBLIOGRAPHY AND/OR REFERENCE

1898 Atlas H. McMaster

also

Dr. Webster

① HDSC Report 1972

## RESTRICTIONS

Original Owner:

Deed Information: Book Number Page , Registry of Deeds