

Massachusetts Cultural Resource Information System

Scanned Record Cover Page

Inventory No:	SBR.212
Historic Name:	Richards, Stowell House
Common Name:	
Address:	43 Richards Rd
City/Town:	Southborough
Village/Neighborhood:	Cordaville
Local No:	8-14
Year Constructed:	c 1840
Architect(s):	
Architectural Style(s):	Victorian Eclectic
Use(s):	Agricultural; Dairy; Single Family Dwelling House
Significance:	Agriculture; Architecture
Area(s):	
Designation(s):	
Building Materials(s):	Roof: Asphalt Shingle Wall: Vinyl Siding; Wood Foundation: Stone, Uncut



The Massachusetts Historical Commission (MHC) has converted this paper record to digital format as part of ongoing projects to scan records of the Inventory of Historic Assets of the Commonwealth and National Register of Historic Places nominations for Massachusetts. Efforts are ongoing and not all inventory or National Register records related to this resource may be available in digital format at this time.

The MACRIS database and scanned files are highly dynamic; new information is added daily and both database records and related scanned files may be updated as new information is incorporated into MHC files. Users should note that there may be a considerable lag time between the receipt of new or updated records by MHC and the appearance of related information in MACRIS. Users should also note that not all source materials for the MACRIS database are made available as scanned images. Users may consult the records, files and maps available in MHC's public research area at its offices at the State Archives Building, 220 Morrissey Boulevard, Boston, open M-F, 9-5.

Users of this digital material acknowledge that they have read and understood the MACRIS Information and Disclaimer (<http://mhc-macris.net/macrisdisclaimer.htm>)

Data available via the MACRIS web interface, and associated scanned files are for information purposes only. THE ACT OF CHECKING THIS DATABASE AND ASSOCIATED SCANNED FILES DOES NOT SUBSTITUTE FOR COMPLIANCE WITH APPLICABLE LOCAL, STATE OR FEDERAL LAWS AND REGULATIONS. IF YOU ARE REPRESENTING A DEVELOPER AND/OR A PROPOSED PROJECT THAT WILL REQUIRE A PERMIT, LICENSE OR FUNDING FROM ANY STATE OR FEDERAL AGENCY YOU MUST SUBMIT A PROJECT NOTIFICATION FORM TO MHC FOR MHC'S REVIEW AND COMMENT. You can obtain a copy of a PNF through the MHC web site (www.sec.state.ma.us/mhc) under the subject heading "MHC Forms."

Commonwealth of Massachusetts
Massachusetts Historical Commission
220 Morrissey Boulevard, Boston, Massachusetts 02125
www.sec.state.ma.us/mhc

This file was accessed on:

Saturday, July 09, 2016 at 2:09: PM

FORM B – BUILDING

MASSACHUSETTS HISTORICAL COMMISSION
MASSACHUSETTS ARCHIVES BUILDING
220 MORRISSEY BOULEVARD
BOSTON, MASSACHUSETTS 02125

Assessor's Number USGS Quad Area(s) Form Number

8-14

Marlboro

212

Town SOUTHBOROUGH

Place (neighborhood or village)



Address 43 Richards Road

Owner Name Stowell Richards

Present residential

Original residential

Construction ca. 1840

Maps / visual analysis

Form Side Gable 1 1/2 story Cape/altere

Architect/Builder unknown

Primary Material:

Foundation stone

Wall/Trim vinyl siding

Roof asphalt

Outbuildings/Secondary Structures none

Sketch Map

Draw a map showing the building's location in relation to the nearest cross streets and/or major natural features. Show all buildings between inventoried building and nearest intersection or natural feature. Label streets including route numbers, if any. Circle and number the inventoried building. Indicate north.

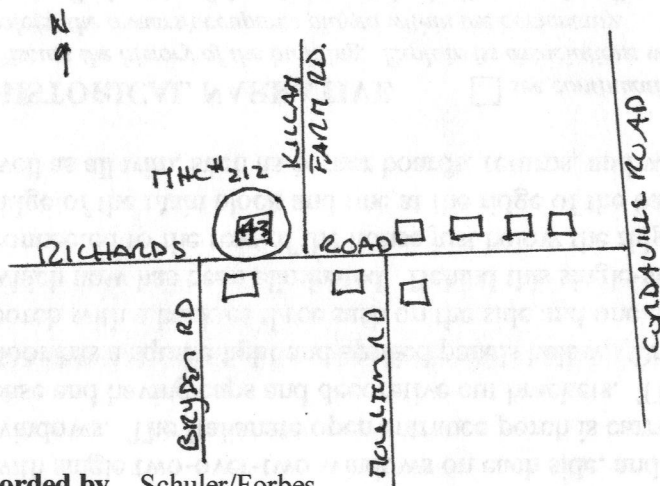

Major Alterations (with dates) open Italianate porch - 1870s, enclosed side porch, wall dormers, connecting barn and house at second story level - early to mid 20th c. Siding and windows - late 20th c.

Condition fair

Moved ☒ no ☐ yes Date n/a

Acreage 25,021 square feet

Setting - Rural road opposite 1950s ranch-style houses, next to new subdivision road is Killam Farm Lane, low stone wall defining entrance to subdivision along east boundary, ledge behind and to side, modest new plantings at house foundation

Recorded by Schuler/Forbes

Organization Southborough Historical Commission

Date (month / year) 2/00

RECEIVED

JUL 03 2000

BUILDING FORM**ARCHITECTURAL DESCRIPTION**☐ see continuation sheet

Describe architectural features. Evaluate the characteristics of this building in terms of other buildings within the community.

The one and one-half story side gable roof Cape Cod cottage is the main block of this modest farmhouse that has been expanded and altered throughout its 150+ year history. The three-bay facade displays a center entrance with single two-over-two windows on each side, and single gabled wall dormers above each of the two first-story windows. The Italianate open entrance porch is carried by square free standing and engaged posts each on a tall base and having caps and decorative cut brackets. The entrance door that is screened by the multi-light storm door has a square light and applied panels below. On the east side of the dwelling there is a one-story enclosed porch with a bank of three sash on the side and one on the front. There was a door to enter this former porch which now has been eliminated. Behind this single-story element is a large two-story, barn-like addition which is connected to the rear of the house just below the ridge. The dwelling has two chimneys; one centered at the ridge of the main block and one at the ridge of the barn-like addition. Siding has covered wood clapboards as well as all trim, such as corner boards, returns, and window surrounds.

HISTORICAL NARRATIVE☐ see continuation sheet

Discuss the history of the building. Explain its associations with local (or state) history. Include uses of the building, and the role(s) the owners/occupants played within the community.

A small cluster of development including a schoolhouse was located on Richards Road prior to the 1830s. This dwelling is consistent with the type of farmhouses that were built in the early to mid 1800s. For at least the second half of the nineteenth century this property was owned by the Richards family after whom the road is named. By the mid 1800s there were two Richards houses near each other; one belonging to J. B. Richards, the other to S. Richards. The 1850 Agricultural Census accounts for Joseph B. Richards' 45-acre farm which coincides with later records. However, **Stowell Richards**' name does not appear until the 1860 assessors records in which he was assessed for a modest amount of real estate. By 1870 he had a 23-acre farm with a house and some livestock. Stowell Richards had married Nancy B. Valentine of Hopkinton in 1837. The relationship between Joseph B. and Stowell Richards should be established as well as with earlier Richards who are known to have been in Southborough in the eighteenth century according to the 1790 census which accounts for John Richards and Ebenezer Richards. By 1881 **George A. Richards** owned the twenty-three acre farm with a house and by the 1890s he was assessed for the house, barn, new barn, two horses and ten cows on his 23-acre farm. Richards may have been a small dairy farmer as he had more cows than many local farmers with the exception of his neighbor, Eldredge McKie at the **Silas C. Simmonds House** at 19 Richards Road. In 1909 George A. Richards, farmer, still owned this farm. He was 64 years old at that time. The 1897 and 1909 assessors reports also account for Ellen Richards owning a 45-acre farm which is the acreage attributed to the Joseph B. Richards farm through the 1880s. The house does not appear on the 1897 map therefore the land must have been inherited by Stowell Richards and his heirs, accounting for the 1909 referral to the 45 acres as "Stowell Richards land." The late twentieth century owner, A. Killam had a 15.61-acre property that recently in the late 1990s has been subdivided with a new subdivision road called Killam Farm Lane.

BIBLIOGRAPHY and/or REFERENCES☐ see continuation sheet

Assessors Reports: 1860, 1870, 1874, 1881, 18894, 1897, 1909.

Atlases/Maps: 1831, 1857 (S. Richards), 1870 (S. Richards), 1898 (G.A. Richards)

Directories: 1900, 1903, 1913

☐ Recommended for listing in the National Register of Historic Places. *If checked, you must attach a completed National Register Criteria Statement form.*



Pl. card 212
USGZ MAP

Southborough
Address 43 Richards Rd.

Original & present Dwelling
owner A. Killiam
public no
Style

Source of date

Literature Indians
Music Other
Development of town/city
Architectural reason for inventorying: 2897
1870 OR part of Area #
3. CONDITION Excellent Good Fair Deteriorated Moved Altered Added

4. DESCRIPTION

FOUNDATION/BASEMENT: High Regular Low Material
WALL COVER: Wood Clapboard Brick Stone Other
ROOF: Ridge Gambrel Flat Hip Mansard
Tower Cupola Dormer windows Balustrade Grillwork
CHIMNEYS: 1 2 3 4 Center End Interior Irregular Cluster Elaborate
STORIES: 1 1/2 3 4 ATTACHMENTS: Wings Ell Shed Porch
PORCHES: 1 2 3 4 PORTICO Balcony
FACADE: Gable end: Front side Ornament
Entrance: Side Front: Center Side Details:
Windows: Spacing: Regular Irregular Identical Varied
Corners: Plain Pilasters Quoins Cornerboards

5. Indicate location of building in relation to nearest cross streets and other buildings

6. Footage of structure from street
Property has feet frontage on street

Recorder

For

Photo # 8-16A Date 1971

SEE REVERSE SIDE

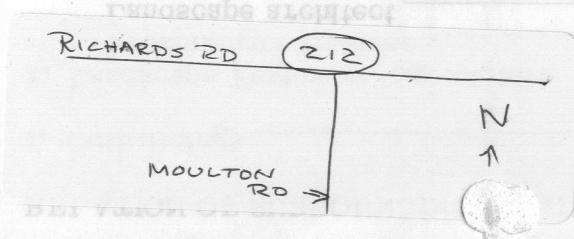

RELATION OF SURROUNDING STRUCTURE

SBR. 212

1. Outbuildings _____
2. Landscape Features: Agriculture Open Wooded Garden: Formal/Informal
 Predominant features _____
 Landscape architect _____
3. Neighboring Structures
 Style: Colonial Federal Greek Revival Gothic Revival Italian Villa Lombard Rom.
 Venetian Gothic Mansard Richardsonian Modern

Use: Residential Commercial Religious Conditions: Excellent Good Fair Deteriorated

GIVE A BRIEF DESCRIPTION OF HISTORIC IMPORTANCE OF SITE (Refer and elaborate on theme circled on front of form)

BOYCHES: 3 3 4 BOYCHES
 STORIES: 1 3 3 4 VILVCHMENIS: 1 3 3 4
 CHIMNEYS: 1 3 3 4
 ROOF: 1 3 3 4
 WALLS: 1 3 3 4
 FOUNDATION/BASEMENT: 1 3 3 4

DESCRIPTION

3. CONDITION Excellent Good Fair Deteriorated Moved Altered Added

BIBLIOGRAPHY AND/OR REFERENCE

1870 Atlas - S. Richards

Name	Owner	Source of date
Preservation	Preservation	Source of date
Collection	Religion/philosophy	Date
Education	Military Affairs	Date
Via/Source	Travel/Communication	Date
Art/Science	Science/Invention	Date
Geography	Commerce/Industry	Date

following premises: (see also separate sheet)
 Building has historical connection with the

RESTRICTIONS

Original Owner: _____
 Deed Information: Book Number _____ Page _____, _____ Registry of Deeds