

Massachusetts Cultural Resource Information System

Scanned Record Cover Page

Inventory No:	SBR.64
Historic Name:	Newton - Temple - Bagley House
Common Name:	
Address:	43 East Main St
City/Town:	Southborough
Village/Neighborhood:	Southborough
Local No:	55-28
Year Constructed:	c 1855
Architect(s):	
Architectural Style(s):	Greek Revival
Use(s):	Agricultural; Single Family Dwelling House
Significance:	Agriculture; Architecture
Area(s):	SBR.Z: East Southborough Center
Designation(s):	
Building Materials(s):	Roof: Asphalt Shingle Wall: Wood; Wood Shingle Foundation: Stone, Uncut; Granite



The Massachusetts Historical Commission (MHC) has converted this paper record to digital format as part of ongoing projects to scan records of the Inventory of Historic Assets of the Commonwealth and National Register of Historic Places nominations for Massachusetts. Efforts are ongoing and not all inventory or National Register records related to this resource may be available in digital format at this time.

The MACRIS database and scanned files are highly dynamic; new information is added daily and both database records and related scanned files may be updated as new information is incorporated into MHC files. Users should note that there may be a considerable lag time between the receipt of new or updated records by MHC and the appearance of related information in MACRIS. Users should also note that not all source materials for the MACRIS database are made available as scanned images. Users may consult the records, files and maps available in MHC's public research area at its offices at the State Archives Building, 220 Morrissey Boulevard, Boston, open M-F, 9-5.

Users of this digital material acknowledge that they have read and understood the MACRIS Information and Disclaimer (<http://mhc-macris.net/macrisdisclaimer.htm>)

Data available via the MACRIS web interface, and associated scanned files are for information purposes only. THE ACT OF CHECKING THIS DATABASE AND ASSOCIATED SCANNED FILES DOES NOT SUBSTITUTE FOR COMPLIANCE WITH APPLICABLE LOCAL, STATE OR FEDERAL LAWS AND REGULATIONS. IF YOU ARE REPRESENTING A DEVELOPER AND/OR A PROPOSED PROJECT THAT WILL REQUIRE A PERMIT, LICENSE OR FUNDING FROM ANY STATE OR FEDERAL AGENCY YOU MUST SUBMIT A PROJECT NOTIFICATION FORM TO MHC FOR MHC'S REVIEW AND COMMENT. You can obtain a copy of a PNF through the MHC web site (www.sec.state.ma.us/mhc) under the subject heading "MHC Forms."

Commonwealth of Massachusetts
Massachusetts Historical Commission
220 Morrissey Boulevard, Boston, Massachusetts 02125
www.sec.state.ma.us/mhc

This file was accessed on:

Friday, July 08, 2016 at 12:41 PM

PL SOUTH

64

V-62 MARL

[Z]

Southborough

et address 43 East Main St

e

original & present dwelling

sent owner Sam'l Cowardin

en to public

e 1866 Style

rce of date Angelina Mattioli

hitect

Architectural reason for inventorying:

Pre 1870

OR part of Area #

3. CONDITION Excellent Good Fair Deteriorated Moved Altered Added

4. DESCRIPTION

FOUNDATION/BASEMENT: High Regular Low Material Stone

WALL COVER: Wood Brick Stone Other

ROOF: Ridge Gambrel Flat Hip Mansard
Tower Cupola Dormer windows Balustrade Grillwork

CHIMNEYS: 1 2 3 4 Center End Interior Irregular Cluster Elaborate

STORIES: 1 2 3 4 ATTACHMENTS: Wings Ell Shed

PORCHES: 1 2 3 4 PORTICO Balcony

FACADE: Gable end: Front/side Ornament

Entrance: Side Front: Center/Side Details: sidelights

Windows: Spacing: Regular/Irregular Identical/Varied

Corners: Plain Pilasters Quoins Cornerboards

5. Indicate location of building in relation to nearest cross streets and other buildings

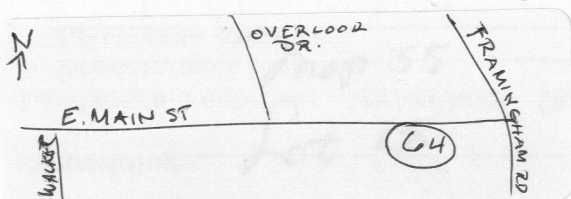
6. Footage of structure from street
Property has feet frontage on street

Recorder

For

Photo #

2-22

Date

1971

SEE REVERSE SIDE

RELATION OF SURROUNDING STRUCTURE

SBR.64

1. Outbuildings

2. Landscape Features: Agriculture Open Wooded Garden: Formal/Informal

Predominant features

Landscape architect

3. Neighboring Structures

Style: Colonial Federal Greek Revival Gothic Revival Italian Villa Lombard Rom.
Venetian Gothic Mansard Richardsonian Modern

Use: Residential Commercial Religious

Conditions: Excellent Good Fair Deteriorated

GIVE A BRIEF DESCRIPTION OF HISTORIC IMPORTANCE OF SITE (Refer and elaborate on theme circled on front of form)

BIBLIOGRAPHY AND/OR REFERENCE

1870 Atlas Parmentier

1898 " D. Bagley

also

L.C. Newton

Bagley

RESTRICTIONS

Original Owner:

Deed Information: Book Number 4557 Page 217, Worcester Co. Registry of Deeds