

# Massachusetts Cultural Resource Information System

## Scanned Record Cover Page

<b>Inventory No:</b>	SBR.270
<b>Historic Name:</b>	Clark, William - Burnett, Rev. Waldo House
<b>Common Name:</b>	Claffin, Elliot House
<b>Address:</b>	36 Main St
<b>City/Town:</b>	Southborough
<b>Village/Neighborhood:</b>	Southborough
<b>Local No:</b>	31; 32; 54-10
<b>Year Constructed:</b>	c 1850
<b>Architect(s):</b>	
<b>Architectural Style(s):</b>	Greek Revival
<b>Use(s):</b>	Agricultural; Multiple Family Dwelling House; Single Family Dwelling House
<b>Significance:</b>	Agriculture; Architecture
<b>Area(s):</b>	SBR.AG: Southborough Town Center SBR.A: Main Street Area
<b>Designation(s):</b>	
<b>Building Materials(s):</b>	Roof: Asphalt Shingle Wall: Vinyl Siding; Wood Foundation: Brick



The Massachusetts Historical Commission (MHC) has converted this paper record to digital format as part of ongoing projects to scan records of the Inventory of Historic Assets of the Commonwealth and National Register of Historic Places nominations for Massachusetts. Efforts are ongoing and not all inventory or National Register records related to this resource may be available in digital format at this time.

The MACRIS database and scanned files are highly dynamic; new information is added daily and both database records and related scanned files may be updated as new information is incorporated into MHC files. Users should note that there may be a considerable lag time between the receipt of new or updated records by MHC and the appearance of related information in MACRIS. Users should also note that not all source materials for the MACRIS database are made available as scanned images. Users may consult the records, files and maps available in MHC's public research area at its offices at the State Archives Building, 220 Morrissey Boulevard, Boston, open M-F, 9-5.

Users of this digital material acknowledge that they have read and understood the MACRIS Information and Disclaimer (<http://mhc-macris.net/macrisdisclaimer.htm>)

Data available via the MACRIS web interface, and associated scanned files are for information purposes only. THE ACT OF CHECKING THIS DATABASE AND ASSOCIATED SCANNED FILES DOES NOT SUBSTITUTE FOR COMPLIANCE WITH APPLICABLE LOCAL, STATE OR FEDERAL LAWS AND REGULATIONS. IF YOU ARE REPRESENTING A DEVELOPER AND/OR A PROPOSED PROJECT THAT WILL REQUIRE A PERMIT, LICENSE OR FUNDING FROM ANY STATE OR FEDERAL AGENCY YOU MUST SUBMIT A PROJECT NOTIFICATION FORM TO MHC FOR MHC'S REVIEW AND COMMENT. You can obtain a copy of a PNF through the MHC web site ([www.sec.state.ma.us/mhc](http://www.sec.state.ma.us/mhc)) under the subject heading "MHC Forms."

Commonwealth of Massachusetts  
Massachusetts Historical Commission  
220 Morrissey Boulevard, Boston, Massachusetts 02125  
[www.sec.state.ma.us/mhc](http://www.sec.state.ma.us/mhc)

This file was accessed on:

Friday, July 08, 2016 at 1:32: PM



Massachusetts Historical Commission

54-10

Marlborough

A

270; 648

Massachusetts Archives Building  
220 Morrissey Boulevard  
Boston, MA 02125

RECEIVED

JUL 03 2000

MASS. HIST. COMM

Town Southborough

Place (neighborhood or village) \_\_\_\_\_

Southborough centerAddress 36 Main StreetHistoric Name William Clark House; Rev. WaldoBurnett HousePresent multi-family dwellingOriginal dwellingDate of Construction ca. 1850maps; visual assessmentStyle Greek RevivalArchitect/Builder unknown

Primary Material:

Foundation brickWall/Trim vinyl sidingRoof asphalt

Outbuildings/Secondary Structures \_\_\_\_\_

19th-C. barn/carriage house, now converted to garage and apartmentMajor Alterations (with dates) E. ell added orenlarged--mid-20th C.; window replacement--ca. 1990Condition fairMoved ☒ no ☐ yes Date N/AAcreage less than one acreSetting Opposite library on south side of Main St.,close to street in line of 19th- and early-20th-century houses.

ii. Number each property for which individual inventory forms have been completed. Label streets, including route numbers, if any. Attach a separate sheet if space is not sufficient here. Indicate north.

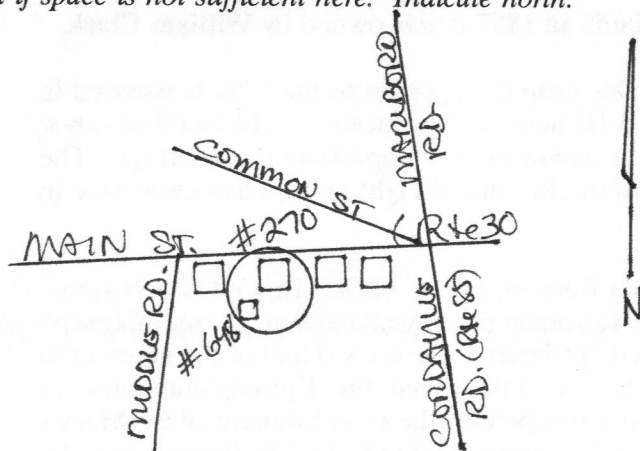
Recorded by Forbes/Schuler, consultantsOrganization Southborough Historical CommissionDate February, 2000

ARCHITECTURAL DESCRIPTION [ ] *see continuation sheet*

*Describe architectural features. Evaluate the characteristics of this building in terms of other buildings within the community.*

A near-contemporary to the similar, but somewhat better-preserved gable-front Greek Revival cottage at 42 Main Street, this building has also grown considerably over the years. It is a long, deep 3 by 5-bay house, 1 1/2-stories, with a one-story hip-roofed west ell flush with the facade. As at 42 Main, gable-roofed dormers break the roofline--one on the south part of the west roof slope, and a wide double dormer in the middle of the east side. Just below the latter, at the first story, is a wide shed-roofed bay. An oriel bay window on the front of the west ell is of unknown date. Three tall brick chimneys rise from various parts of the roof.

As at 42 Main, the two-bay front gable is enclosed to form a pediment-like form. Most of the molded, boxed cornice remains, but much of the rest of the house trim has been lost to siding or window changes. The windows have recently been replaced with vinyl inserts, and their openings reduced in size. They are presently trimmed with vinyl louvered shutters.

The main sidehall entry is positioned at the east end of the three-bay main facade, under a twentieth-century canopy on square posts, with a square-doweled balustrade. Typical of a Greek Revival house, the doorway is recessed, and has full-length five-pane sidelights. The door is a four-paneled type, probably original to the house. At the south end of the west elevation, a hip-roofed porch on square posts, with a turned balustrade, shelters another entry.

Standing just southwest of the house is a small nineteenth-century gable-front **barn** (#648). Also clad in vinyl siding, it retains its original proportions, but has been converted to a two-car garage at the first story, and a small apartment at the second. The facade contains a pair of wood panel-and-glass overhead garage doors, and an off-center triple window above them. A wooden stair rises up the east side of the building to an entry at a modern shed dormer. Two smaller gabled wall dormers are positioned on the west side.

HISTORICAL NARRATIVE [ ] *see continuation sheet*

*Explain history of the building. Explain its associations with local (or state) history. Include uses of the building, and the role(s) the owners/occupants played within the community.*

While it is not certain for whom this little house was built, in 1857 it was owned by **William Clark**.

Although the map of 1870 shows "C. B. Claflin" here, this property appears to have been assessed in that year to **Elliot Claflin**, who owned a small farm of 3 1/2 acres at this location. He had four cows, which he apparently kept in the little barn that has been converted to an apartment and garage. The property stretched southwest to Middle Road. Mr. Claflin also owned eight more acres elsewhere in Southborough.

By 1898 the house had been acquired by the **Rev. Waldo Burnett**, pastor of St. Mark's Church across the street. Waldo Burnett (1855-1935), who lived here for many years, was the fourth son of Joseph Burnett, Southborough's major patron and acknowledged patriarch of the second half of the nineteenth century. His parents were devout Episcopalians, who had introduced the Episcopalian faith to Southborough in 1850. His father had been the primary force behind the establishment of St. Mark's Church, which he had largely paid for, and for which he had given the land. Waldo Burnett was the most extreme Anglophile in a family which was full of Anglophiles, and had been sent to England to study for the ministry. Appointed acting Rector of St. Mark's Church in 1883, he became full-time Rector in 1886, a post which he held until 1900.

[x] Recommended for listing in the National Register of Historic Places. *If checked, a completed National Register Criteria Statement form is attached.*



## INVENTORY FORM CONTINUATION SHEET

Community

Property

Southborough

36 Main Street

Massachusetts Historical Commission  
Massachusetts Archives Building  
220 Morrissey Boulevard  
Boston, Massachusetts 02125

Area(s)  
A

Form No.  
270, 648

BIBLIOGRAPHY and/or REFERENCES [ ] *see continuation sheet*

Maps and Atlases: 1857 (Wm. Clark); 1870 (CB Claflin); 1898 (Rev. W. Burnett).

The Marlborough Directory. Various dates and publishers.

Town of Southborough: Vital Records; Annual Reports and Tax Valuations, various dates.



34, 36 Main St.



36 Main St.

Massachusetts Historical Commission  
220 Morrissey Boulevard  
Boston, Massachusetts 02125

Community  
Southborough

Property Address  
36 Main Street

Area(s)  
A

Form No(s).  
270

## National Register of Historic Places Criteria Statement Form

Check all that apply:

☐ Individually eligible    ☐ Eligible only in a historic district  
☒ Contributing to a potential historic district    ☐ Potential historic district

Criteria: ☒ A    ☐ B    ☒ C    ☐ D

Criteria Considerations:    ☐ A    ☐ B    ☐ C    ☐ D    ☐ E    ☐ F    ☐ G

Statement of Significance by Forbes/Schuler, Consultants

*The criteria that are checked in the above sections must be justified here.*

This house is eligible for the National Register as a contributing property in a district encompassing the historic residential and institutional meetinghouse center of the town. Under Criterion A, it is significant for its association with both the influential Burnett family and St. Mark's Church, as it was the turn-of-the-century residence of the Rev. Waldo Burnett, pastor of the church from 1886 to 1900. In spite of the loss of some architectural features, it meets Criterion C as an example of vernacular house of the Greek Revival period indicative of the work of a local master-carpenters.

The property retains integrity of location, design, materials, workmanship, feeling, setting and association.



PHD

32 # 31

(A)

(270)

Southborough, Mass Pl. South

Address 36 Main Street US 62 main

Original & present 2 Family Dwelling

owner Francis E& Eva M. Ramelli

public \_\_\_\_\_

Style N.E. Cottage - C.R. trans

of date \_\_\_\_\_

ct \_\_\_\_\_

Architectural reason for inventorying: \_\_\_\_\_

OR part of Area # \_\_\_\_\_

3. CONDITION Excellent Good Fair Deteriorated Moved Altered Added \_\_\_\_\_

#### 4. DESCRIPTION

FOUNDATION/BASEMENT: High Regular Low Material BRICK

WALL COVER: Wood \_\_\_\_\_ Brick Stone Other \_\_\_\_\_

ROOF: Ridge Gambrel Flat Hip Mansard RIDGE AND HIP  
Tower Cupola Dormer windows Balustrade Grillwork \_\_\_\_\_

CHIMNEYS: 1 2 3 4 Center End Interior Irregular Cluster Elaborate

STORIES: 1 2 3 4 ATTACHMENTS: Wings Ell Shed \_\_\_\_\_

PORCHES: 1 2 3 4 PORTICO in the front Balcony

FACADE: Gable end: Front/side Ornament \_\_\_\_\_

Entrance: Side Front Center/Side Details: \_\_\_\_\_

Windows: Spacing: Regular Irregular Identical Varied

Corners: Plain Pilasters Quoins Cornerboards \_\_\_\_\_

5. Indicate location of building in relation to nearest cross streets and other buildings

6. Footage of structure from street 15 ft.  
Property has 88 feet frontage on street

MAP 54  
LOT 10

Recorder \_\_\_\_\_

For \_\_\_\_\_

Photo # \_\_\_\_\_ Date \_\_\_\_\_

SEE REVERSE SIDE



# RELATION OF SURROUNDING STRUCTURE

SBR.270

1. Outbuildings GARAGE WITH UPSTAIRS APARTMENT

2. Landscape Features: Agriculture Open Wooded Garden: Formal/Informal

Predominant features

Landscape architect

3. Neighboring Structures DWELLINGS

Style: Colonial Federal Greek Revival Gothic Revival Italian Villa Lombard Rom.

Venetian Gothic Mansard Richardsonian Modern

Use: (Residential Commercial) Religious

BOTH

Conditions: Excellent (Good) Fair Deteriorated

GIVE A BRIEF DESCRIPTION OF HISTORIC IMPORTANCE OF SITE (Refer and elaborate on theme circled on front of form)

## BIBLIOGRAPHY AND/OR REFERENCE

## RESTRICTIONS

Original Owner:

Deed Information: Book Number \_\_\_\_\_ Page \_\_\_\_\_, \_\_\_\_\_ Registry of Deeds