

Massachusetts Cultural Resource Information System

Scanned Record Cover Page

Inventory No: SBR.127
Historic Name: Golden, S. House
Common Name: Hodge, R. B. - Koler House
Address: 240 Parkerville Rd
City/Town: Southborough
Village/Neighborhood: Southville
Local No: 2-05
Year Constructed: c 1850
Architect(s):
Architectural Style(s): Greek Revival
Use(s): Single Family Dwelling House
Significance: Architecture
Area(s): SBR.B: Southville
Designation(s):
Building Materials(s): Roof: Asphalt Shingle
Wall: Wood Clapboard; Wood



The Massachusetts Historical Commission (MHC) has converted this paper record to digital format as part of ongoing projects to scan records of the Inventory of Historic Assets of the Commonwealth and National Register of Historic Places nominations for Massachusetts. Efforts are ongoing and not all inventory or National Register records related to this resource may be available in digital format at this time.

The MACRIS database and scanned files are highly dynamic; new information is added daily and both database records and related scanned files may be updated as new information is incorporated into MHC files. Users should note that there may be a considerable lag time between the receipt of new or updated records by MHC and the appearance of related information in MACRIS. Users should also note that not all source materials for the MACRIS database are made available as scanned images. Users may consult the records, files and maps available in MHC's public research area at its offices at the State Archives Building, 220 Morrissey Boulevard, Boston, open M-F, 9-5.

Users of this digital material acknowledge that they have read and understood the MACRIS Information and Disclaimer (<http://mhc-macris.net/macrisdisclaimer.htm>)

Data available via the MACRIS web interface, and associated scanned files are for information purposes only. THE ACT OF CHECKING THIS DATABASE AND ASSOCIATED SCANNED FILES DOES NOT SUBSTITUTE FOR COMPLIANCE WITH APPLICABLE LOCAL, STATE OR FEDERAL LAWS AND REGULATIONS. IF YOU ARE REPRESENTING A DEVELOPER AND/OR A PROPOSED PROJECT THAT WILL REQUIRE A PERMIT, LICENSE OR FUNDING FROM ANY STATE OR FEDERAL AGENCY YOU MUST SUBMIT A PROJECT NOTIFICATION FORM TO MHC FOR MHC'S REVIEW AND COMMENT. You can obtain a copy of a PNF through the MHC web site (www.sec.state.ma.us/mhc) under the subject heading "MHC Forms."

Commonwealth of Massachusetts
Massachusetts Historical Commission
220 Morrissey Boulevard, Boston, Massachusetts 02125
www.sec.state.ma.us/mhc

This file was accessed on:

Saturday, July 09, 2016 at 1:51: PM



PL 5'ville 127

W-111111 B

Southborough

Address 40 Parkville Rd

Original & present Dwelling

Owner Orman Samborn

Public no

Style C. 1850

Literature _____ Indians _____ source of date _____
 Music _____ Other _____
 Development of town/city _____ Architect _____
 Architectural reason for inventorying: _____
 PR 1870 _____ OR part of Area # _____

3. CONDITION Excellent Good Fair Deteriorated Moved Altered Added

4. DESCRIPTION

FOUNDATION/BASEMENT: High Regular Low Material _____
 WALL COVER: Wood clapboard Brick Stone Other _____
 ROOF: Ridge Gambrel Flat Hip Mansard _____
 Tower Cupola Dormer windows Balustrade Grillwork _____
 CHIMNEYS: 1 2 3 4 Center End Interior Irregular Cluster Elaborate tipsy
 STORIES: 1 2 3 4 ATTACHMENTS: Wings Ell Shed Barn attached to ell
 PORCHES: 1 2 3 4 glazed in side PORTICO _____ Balcony _____
 FACADE: Gable end: Front/side Ornament _____
 Entrance: Side Front: Center/Side Details: _____
 Windows: Spacing: Regular/Irregular Identical/Varied attired
 Corners: Plain Pilasters Quoins Cornerboards

5. Indicate location of building in relation to nearest cross streets and other buildings
 6. Footage of structure from street _____
 Property has _____ feet frontage on street

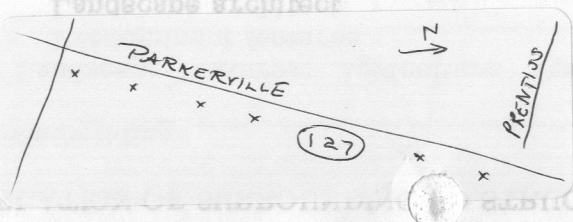

Recorder _____
 For _____
 Photo # 4-9 Date 1971

SEE REVERSE SIDE

RELATION OF SURROUNDING STRUCTURE

- 1. Outbuildings _____
- 2. Landscape Features: Agriculture Open Wooded Garden: Formal/Informal
 Predominant features _____
 Landscape architect _____
- 3. Neighboring Structures
 Style: Colonial Federal Greek Revival Gothic Revival Italian Villa Lombard Rom.
 Venetian Gothic Mansard Richardsonian Modern
 Use: Residential Commercial Religious Conditions: Excellent Good Fair Deteriorated

GIVE A BRIEF DESCRIPTION OF HISTORIC IMPORTANCE OF SITE (Refer and elaborate on theme circled on front of form)

Architecture - windows used to go from floor to ceiling
porch removed from back was hand-peeled

BIBLIOGRAPHY AND/OR REFERENCE

1870 Atlas S. Golden
 1898 " R.B. Dodge
 Koler
 Sauborn

Ref: (Mr Sauborn) Grandmother bought from Sally Smith 1875
Mr. Sauborn's mother born in this house

RESTRICTIONS

Original Owner: _____
 Deed Information: Book Number _____ Page _____, _____ Registry of Deeds