

Massachusetts Cultural Resource Information System

Scanned Record Cover Page

Inventory No:	SBR.15
Historic Name:	Fisher, Francis House
Common Name:	
Address:	22 Fisher Rd
City/Town:	Southborough
Village/Neighborhood:	
Local No:	72-4
Year Constructed:	r 1780
Architect(s):	
Architectural Style(s):	Federal; Georgian
Use(s):	Agricultural; Dairy; Poultry Farm; Single Family Dwelling House
Significance:	Agriculture; Architecture
Area(s):	
Designation(s):	
Building Materials(s):	Roof: Asphalt Shingle Wall: Wood Clapboard; Wood Foundation: Stone, Uncut; Granite; Stone, Cut



DEMOLISHED

The Massachusetts Historical Commission (MHC) has converted this paper record to digital format as part of ongoing projects to scan records of the Inventory of Historic Assets of the Commonwealth and National Register of Historic Places nominations for Massachusetts. Efforts are ongoing and not all inventory or National Register records related to this resource may be available in digital format at this time.

The MACRIS database and scanned files are highly dynamic; new information is added daily and both database records and related scanned files may be updated as new information is incorporated into MHC files. Users should note that there may be a considerable lag time between the receipt of new or updated records by MHC and the appearance of related information in MACRIS. Users should also note that not all source materials for the MACRIS database are made available as scanned images. Users may consult the records, files and maps available in MHC's public research area at its offices at the State Archives Building, 220 Morrissey Boulevard, Boston, open M-F, 9-5.

Users of this digital material acknowledge that they have read and understood the MACRIS Information and Disclaimer (<http://mhc-macris.net/macrisdisclaimer.htm>)

Data available via the MACRIS web interface, and associated scanned files are for information purposes only. THE ACT OF CHECKING THIS DATABASE AND ASSOCIATED SCANNED FILES DOES NOT SUBSTITUTE FOR COMPLIANCE WITH APPLICABLE LOCAL, STATE OR FEDERAL LAWS AND REGULATIONS. IF YOU ARE REPRESENTING A DEVELOPER AND/OR A PROPOSED PROJECT THAT WILL REQUIRE A PERMIT, LICENSE OR FUNDING FROM ANY STATE OR FEDERAL AGENCY YOU MUST SUBMIT A PROJECT NOTIFICATION FORM TO MHC FOR MHC'S REVIEW AND COMMENT. You can obtain a copy of a PNF through the MHC web site (www.sec.state.ma.us/mhc) under the subject heading "MHC Forms."

Commonwealth of Massachusetts
Massachusetts Historical Commission
220 Morrissey Boulevard, Boston, Massachusetts 02125
www.sec.state.ma.us/mhc

This file was accessed on:

Friday, July 08, 2016 at 12:46 PM

Massachusetts Historical Commission

72-4

Marlborough

15

Massachusetts Archives Building
220 Morrissey Boulevard
Boston, MA 02125

DEMOLISHED

Town Southborough

ne (neighborhood or village) _____

Address 22 Fisher RoadHistoric Name Francis Fisher HouseType: Present dwellingOriginal dwellingDate of Construction late 18th centurySource visual assessment; traditionStyle/Form Georgian/Federal vernacular,
with Greek Revival detailsArchitect/Builder unknown

Exterior Material:

Foundation granite block and fieldstoneWall/Trim wood clapboardRoof asphalt

Outbuildings/Secondary Structures _____

modern shed; swimming pool surrounded
by picket fenceMajor Alterations (with dates) ca. 1840s:Grk Revival doorway; ca. 1870s: 2/2 windows,facade bay window; mid-20th C.: jalousied
door in NE ell, E. ridge chimney taken downCondition goodMoved [x]no []yes Date N/AAcreage 1.5 acresSetting Faces SE over former RR bed atcorner of new side st., in area under develop-
ment with large single-family houses.

Sketch Map

Draw a map of the area indicating properties within
it. Number each property for which individual
inventory forms have been completed. Label streets,
including route numbers, if any. Attach a separate
sheet if space is not sufficient here. Indicate north.

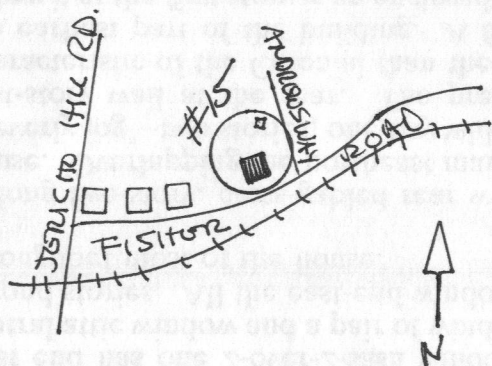
Recorded by Anne Forbes, consultantOrganization Southborough Historical Comm.Date 08 1999 June, 1999

BUILDING FORM

SBR.15

ARCHITECTURAL DESCRIPTION ☒ see continuation sheet

Describe architectural features. Evaluate the characteristics of this building in terms of other buildings within the community.

If its traditional construction date is correct, the Francis Fisher House is an example of a late Georgian vernacular, eighteenth-century Southborough farmhouse that was enlarged and updated with details of later styles at various times during the nineteenth century. It is a 2 1/2-story side-gabled building with a five-bay facade and end walls of differing fenestration--the west end has one 2-over-2-sash window at each story, centrally placed; the east end has a central attic window and a pair of windows toward the rear section of the wall at both first and second stories. All the east-end windows are 6-over-6's, contrasting with the 2-over-2's found throughout most of the house.

A long two-story, cross-gabled rear wing extends northward from the rear wall of the main house. Overlapping the northeast main house corner is a rare example in Southborough of a "Beverly jog"--two stories, one-bay wide at the front, its shed roof descending steeply to a low first-story wall at the rear. The presence of the jog, a feature which is somewhat more characteristic of the Colonial than the Federal era, suggests that the east end of the house is the earliest part of the building. A 6/6 window occupies the upper facade wall of the jog; below it at the first story is an enclosed entry under a pent roof with modern jalousied windows and door. (Cont.)

HISTORICAL NARRATIVE ☐ see continuation sheet

Explain history of the building. Explain its associations with local (or state) history. Include uses of the building, and the role(s) the owners/occupants played within the community.

While a house appears at this location on the 1831 map of Southborough, further research will be necessary to determine the identity of its original owner. Over 180 acres of land in this part of Southborough were owned by members of the Fisher family through most of the nineteenth century, and farmer Francis Fisher apparently came into the ownership of this particular farm by the 1840s. Mr. Fisher, who had been a sea captain in his youth, was prominent in local affairs, and served Southborough for many years as a Selectman, as well as in other town offices. He was also a State Representative in the General Court, and a Deacon in the church.

Like many farmers in Southborough, after the Civil War Francis Fisher had a medium-size dairy herd of eleven cows here. Records from 1870 show that his farm was larger than most, with 65 acres, plus 27 more at another location. In addition to his cows he also kept two horses, two pigs, and had both a barn and a granary on the property.

Francis Fisher died in about 1890, and after a brief period under his heirs, the farm came under the ownership of his son, George Clinton Fisher (b. 1847). In 1879 George Fisher had acquired the adjacent 110-acre Southborough/Marlborough farm of his late uncle, Charles Fisher, and the acquisition of his father's property made him one of the largest landowners in Southborough. At the turn of the century he had 21 cows, a bull, three horses, a poultry flock of 100 fowls, and had added a windmill to the property. He remained here through at least 1904, but by 1915 had moved to Stowe Road.

[x] Recommended for listing in the National Register of Historic Places. *If checked, a completed National Register Criteria Statement form is attached.*

INVENTORY FORM CONTINUATION SHEET

Community

Property

Southborough

22 Fisher Road

Massachusetts Historical Commission
Massachusetts Archives Building
220 Morrissey Boulevard
Boston, Massachusetts 02125

Area(s)

Form No.
15

ARCHITECTURAL DESCRIPTION, cont.

It appears that the house formerly had twin ridge chimneys. Only the base of the eastern chimney, which was still there in 1971, remains, as its upper section has been taken down above the roof. Another chimney rises from the east edge of the roof ridge of the wing. The house trim includes a molded, boxed cornice with a prominent bed molding, and flat cornerboards. Greek Revival features include the main center doorway, which has a four-panel door with wide applied moldings and full-length, six-pane sidelights. Probably updated in the 1840s, the doorway has a high, flat frieze, projecting cornice, and flat pilasters with molded caps. The windows have flat surrounds; some are fitted with modern louvered wood shutters. A single one-story polygonal bay window just east of the door, with a paneled apron below its 2-over-2-sash, is of a type typical of the 1870s. Another entry, in the rear bay of the east gable-end wall, is fitted with an early-modern glass-and-panel door and a mid-twentieth-century aluminum hood.

Maps show what appears to have been a large barn directly behind the house. While no old outbuilding survives on this property, reminders of its rural origins remain in the fieldstone walls lining portions of both roadsides. The small front yard is built up in nineteenth-century fashion with a low retaining wall of rough-cut stone; the same type of stone work continues west of the front yard in a ca. 4-foot-high wall. A fieldstone wall along the driveway may be of twentieth-century date.

BIBLIOGRAPHY and/or REFERENCES [] *see continuation sheet*

Maps and Atlases: 1831; 1857 (F. Fisher); 1870 (F. Fisher); 1898 (GC Fisher).

Hurd, D. Hamilton. History of Worcester County, I. Philadelphia: JW Lewis, 1889.

The Marlborough Directory. Various dates and publishers.

Noble, Richard. Fences of Stone: a History of Southborough, MA. Portsmouth, NH: Peter Randall, 1990.

Simpson, Louise. "Old Houses in Southborough". Paper presented to Southborough Woman's Club, 1904.

Town of Southborough: Vital Records; Assessor's Reports, various dates.

Worcester County Registry of Deeds: 1055/348-351; 1055/353.



Massachusetts Historical Commission
Massachusetts Archives Building
220 Morrissey Boulevard
Boston, Massachusetts 02125

Community

Property Address

Southborough

22 Fisher Road

Area(s)

Form No(s).

~~25~~ 15

National Register of Historic Places Criteria Statement Form

Check all that apply:

☒ Individually eligible ☐ Eligible only in a historic district
☐ Contributing to a potential historic district ☐ Potential historic district

Criteria: ☒ A ☐ B ☒ C ☐ D

Criteria Considerations: ☐ A ☐ B ☐ C ☐ D ☐ E ☐ F ☐ G

Statement of Significance by Anne Forbes
The criteria that are checked in the above sections must be justified here.

The Francis Fisher House meets Criteria A and C of the National Register individually as an important rural farmhouse associated with the Fisher family, farmers who for at least two generations dominated rural northwest Southborough along the Westborough Road, later named Fisher Road.

Both Francis and George Fisher were important for their role as local farmers; Francis was also locally prominent as a Selectman, State Representative, and a Deacon in the church. For the well-preserved architecture of its eighteenth- and nineteenth-century farmhouse and portions of its immediate landscape setting, the property also meets Criterion C.

The property retains integrity of location, design, setting, materials, workmanship, feeling, and association.



p16 15

--	--	--

Town Southborough
 Street address 22 Fisher Road
 Name _____
 Original use dwelling
 Present use _____
 Present owner David Taylor
 Known to public _____
 Date 1700's Style _____

Art/Sculpture
 Education
 Government
 Literature
 Music

Travel/Communication
 Military affairs
 Religion/philosophy
 Indians
 Development of town/city

Source of date owner
 Architect _____

3. CONDITION: Excellent Good Fair Deteriorated Moved Altered Added

4. DESCRIPTION

FOUNDATION/BASEMENT: High Regular Low Material: Stone

WALL COVER: Wood Clapboard Brick Stone Other _____

ROOF: Ridge Gambrel Flat Hip Mansard
 Tower Cupola Dormer windows Balustrade Grillwork _____

CHIMNEYS: 1 2 3 4 Center End Interior Irregular Cluster Elaborate

STORIES: 1 2 3 4 ATTACHMENTS: Wings Ell Shed _____

PORCHES: 1 2 3 4 _____ PORTICO _____ Balcony

FACADE: Gable end: Front Side Ornament: _____

Entrance: Side Front: Center/Side Details: side lights

Windows: Spacing: Regular Irregular Identical/Varied bay window front

Corners: Plain Pilasters Quoins Cornerboards

5. Indicate location of structure in relation to nearest cross streets and other buildings

6. Footage of structure from street 25
Property has 40 feet frontage on street

Recorder _____

For _____

Photo 1-34A Date 1971

SEE REVERSE SIDE

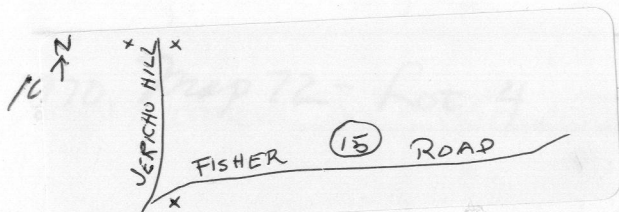

RELATION OF SURROUNDING TO STRUCTURE

SBR.15

1. Outbuildings

2. Landscape Features: Agriculture Open Wooded Garden: Formal/Informal

Predominant features

Landscape architect

3. Neighboring Structures

Style: Colonial Federal Greek Revival Gothic Revival Italian Villa Lombard Rom.

Venetian Gothic Mansard Richardsonian Modern

Use: Residential Commercial Religious

Conditions: Excellent Good Fair Deteriorated

GIVE A BRIEF DESCRIPTION OF HISTORIC IMPORTANCE OF SITE (Refer and elaborate on theme circled on front of form)

Dutch oven / beehive

BIBLIOGRAPHY AND/OR REFERENCE

1870 Atlas - Francis Fisher

1898 " G. E. Fisher

RESTRICTIONS

Original Owner:

Deed Information: Book Number 2989 Page 576 Worcester Co. Registry of Deeds