

Massachusetts Cultural Resource Information System

Scanned Record Cover Page

Inventory No: SBR.148
Historic Name: Noonan, William House
Common Name:
Address: 2 Wood St
City/Town: Southborough
Village/Neighborhood: Southville
Local No: 2-34
Year Constructed: c 1850
Architect(s):
Architectural Style(s): Greek Revival
Use(s): Single Family Dwelling House
Significance: Architecture
Area(s): SBR.B: Southville
Designation(s):
Building Materials(s): Roof: Asphalt Shingle
Wall: Wood Clapboard; Wood
Foundation: Stone, Cut; Granite



The Massachusetts Historical Commission (MHC) has converted this paper record to digital format as part of ongoing projects to scan records of the Inventory of Historic Assets of the Commonwealth and National Register of Historic Places nominations for Massachusetts. Efforts are ongoing and not all inventory or National Register records related to this resource may be available in digital format at this time.

The MACRIS database and scanned files are highly dynamic; new information is added daily and both database records and related scanned files may be updated as new information is incorporated into MHC files. Users should note that there may be a considerable lag time between the receipt of new or updated records by MHC and the appearance of related information in MACRIS. Users should also note that not all source materials for the MACRIS database are made available as scanned images. Users may consult the records, files and maps available in MHC's public research area at its offices at the State Archives Building, 220 Morrissey Boulevard, Boston, open M-F, 9-5.

Users of this digital material acknowledge that they have read and understood the MACRIS Information and Disclaimer (<http://mhc-macris.net/macrisdisclaimer.htm>)

Data available via the MACRIS web interface, and associated scanned files are for information purposes only. THE ACT OF CHECKING THIS DATABASE AND ASSOCIATED SCANNED FILES DOES NOT SUBSTITUTE FOR COMPLIANCE WITH APPLICABLE LOCAL, STATE OR FEDERAL LAWS AND REGULATIONS. IF YOU ARE REPRESENTING A DEVELOPER AND/OR A PROPOSED PROJECT THAT WILL REQUIRE A PERMIT, LICENSE OR FUNDING FROM ANY STATE OR FEDERAL AGENCY YOU MUST SUBMIT A PROJECT NOTIFICATION FORM TO MHC FOR MHC'S REVIEW AND COMMENT. You can obtain a copy of a PNF through the MHC web site (www.sec.state.ma.us/mhc) under the subject heading "MHC Forms."

Commonwealth of Massachusetts
Massachusetts Historical Commission
220 Morrissey Boulevard, Boston, Massachusetts 02125
www.sec.state.ma.us/mhc

This file was accessed on:

Saturday, July 09, 2016 at 5:38: PM



148

P. S. VILL
W. F. TIDMAN

B

Southborough

Address 2 Wood Street

Original & present Dwelling

Owner W. F. Tidman

Public No

Style C-1850

Literature _____ Indians _____ Source of date _____
 Music _____ Other _____
 Development of town/city _____ Architect _____
 Architectural reason for inventorying: Pre 1870
 OR part of Area # _____

3. CONDITION Excellent Good Fair Deteriorated Moved Altered Added _____

4. DESCRIPTION

FOUNDATION/BASEMENT: High Regular Low Material Granite Sills

WALL COVER: Wood Clapboards Brick Stone Other _____

ROOF: Ridge Gambrel Flat Hip Mansard
 Tower Cupola Dormer windows Balustrade Grillwork _____

CHIMNEYS: 1 2 3 4 Center End Interior Irregular Cluster Elaborate lined

STORIES: 1 2 3 4 ATTACHMENTS: Wings Ell Shed _____

PORCHES: 1 2 3 4 Back PORTICO Balcony

FACADE: Gable end: Front/side Ornament _____

Entrance: Side Front: Center/Side Details: _____

Windows: Spacing: Regular Irregular Identical/Varied _____

Corners: Plain Pilasters Quoins Cornerboards _____

5. Indicate location of building in relation to nearest cross streets and other buildings

6. Footage of structure from street _____
 Property has _____ feet frontage on street

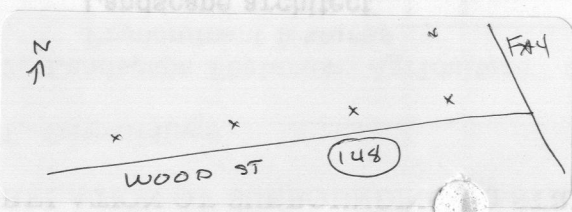

Recorder _____

For _____

Photo # 4-29 Date 1971

SEE REVERSE SIDE

RELATION OF SURROUNDING STRUCTURE

- 1. Outbuildings _____
- 2. Landscape Features: Agriculture Open Wooded Garden: Formal/Informal
 Predominant features _____
 Landscape architect _____
- 3. Neighboring Structures
 Style: Colonial Federal Greek Revival Gothic Revival Italian Villa Lombard Rom.
 Venetian Gothic Mansard Richardsonian Modern
 Use: Residential Commercial Religious Conditions: Excellent Good Fair Deteriorated

GIVE A BRIEF DESCRIPTION OF HISTORIC IMPORTANCE OF SITE (Refer and elaborate on theme circled on front of form)

Built around Civil War

BIBLIOGRAPHY AND/OR REFERENCE

1870 Atlas - William Hooper

1898 " "

RESTRICTIONS

Original Owner: _____
Deed Information: Book Number _____ Page _____, _____ Registry of Deeds