

# Massachusetts Cultural Resource Information System

## Scanned Record Cover Page

<b>Inventory No:</b>	SBR.210
<b>Historic Name:</b>	Williams, L. House
<b>Common Name:</b>	Sommerman, Henry House
<b>Address:</b>	188 Cordaville Rd
<b>City/Town:</b>	Southborough
<b>Village/Neighborhood:</b>	
<b>Local No:</b>	20-29
<b>Year Constructed:</b>	c 1860
<b>Architect(s):</b>	
<b>Architectural Style(s):</b>	Greek Revival
<b>Use(s):</b>	Agricultural; Poultry Farm; Single Family Dwelling House
<b>Significance:</b>	Agriculture; Architecture
<b>Area(s):</b>	
<b>Designation(s):</b>	
<b>Building Materials(s):</b>	Roof: Asphalt Shingle Wall: Wood Clapboard; Wood Foundation: Stone, Uncut; Granite



The Massachusetts Historical Commission (MHC) has converted this paper record to digital format as part of ongoing projects to scan records of the Inventory of Historic Assets of the Commonwealth and National Register of Historic Places nominations for Massachusetts. Efforts are ongoing and not all inventory or National Register records related to this resource may be available in digital format at this time.

The MACRIS database and scanned files are highly dynamic; new information is added daily and both database records and related scanned files may be updated as new information is incorporated into MHC files. Users should note that there may be a considerable lag time between the receipt of new or updated records by MHC and the appearance of related information in MACRIS. Users should also note that not all source materials for the MACRIS database are made available as scanned images. Users may consult the records, files and maps available in MHC's public research area at its offices at the State Archives Building, 220 Morrissey Boulevard, Boston, open M-F, 9-5.

Users of this digital material acknowledge that they have read and understood the MACRIS Information and Disclaimer (<http://mhc-macris.net/macrisdisclaimer.htm>)

Data available via the MACRIS web interface, and associated scanned files are for information purposes only. THE ACT OF CHECKING THIS DATABASE AND ASSOCIATED SCANNED FILES DOES NOT SUBSTITUTE FOR COMPLIANCE WITH APPLICABLE LOCAL, STATE OR FEDERAL LAWS AND REGULATIONS. IF YOU ARE REPRESENTING A DEVELOPER AND/OR A PROPOSED PROJECT THAT WILL REQUIRE A PERMIT, LICENSE OR FUNDING FROM ANY STATE OR FEDERAL AGENCY YOU MUST SUBMIT A PROJECT NOTIFICATION FORM TO MHC FOR MHC'S REVIEW AND COMMENT. You can obtain a copy of a PNF through the MHC web site ([www.sec.state.ma.us/mhc](http://www.sec.state.ma.us/mhc)) under the subject heading "MHC Forms."

Commonwealth of Massachusetts  
Massachusetts Historical Commission  
220 Morrissey Boulevard, Boston, Massachusetts 02125  
[www.sec.state.ma.us/mhc](http://www.sec.state.ma.us/mhc)

This file was accessed on:

Friday, July 08, 2016 at 12:12 PM

**FORM B – BUILDING**

Assessor's Number USGS Quad Area(s) Form Number

20-29 Marlboro 210 754

**MASSACHUSETTS HISTORICAL COMMISSION**

**Town** SOUTHBOROUGH

**Place** (neighborhood or village)

**Address** 188 Cordaville Road

**Historic Name** L. Williams

**Uses: Present** residential

**Original** residential

**Date of Construction** ca. 1860

**Source** maps and visual

**Style/Form** Greek Revival

**Architect/Builder** unknown

**Exterior Material:**

**Foundation** granite

**Wall/Trim** wood clapboard / wood trim

**Roof** asphalt

**Outbuildings/Secondary Structures** large clapboard late 19<sup>th</sup> c. barn with 6/6 windows, main door on side (now garage), rear addition - 20<sup>th</sup> c. vertical board shed behind house.

**Major Alterations** (with dates) Rear ell, shed roof dormer, bay window - mid 1900s.

**Condition** good

**Moved**  no  yes **Date** n/a

**Acreage** .79 acres

**Setting** - Main north-south route connecting Cordaville and Southborough Center. Among mixed residential 1960s capes and some 19<sup>th</sup> c. farmhouses. Large pine trees shielding house on north side. Wooded area and ledge behind.



buildings between inventoried building and nearest intersection or natural feature. Label streets including route numbers, if any. Circle and number the inventoried building. Indicate north.

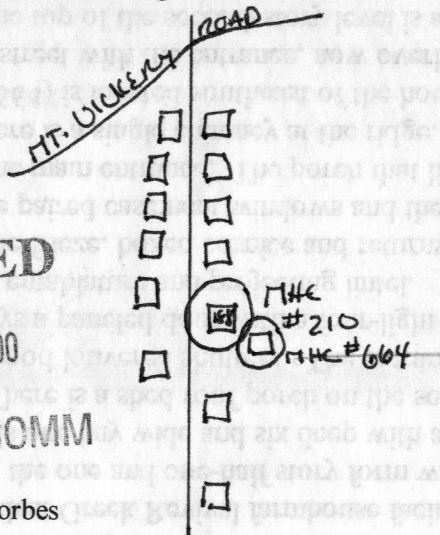

RECEIVED

JUL 03 2000

MASS. HIST. COMM

**Recorded by** Schuler/Forbes

**Organization** Southborough Historical Commission

**Date** (month / year) 2/00

### BUILDING FORM

#### ARCHITECTURAL DESCRIPTION see continuation sheet

Describe architectural features. Evaluate the characteristics of this building in terms of other buildings within the community.

Once a small and modest Greek Revival farmhouse facing south, the dwelling has been enlarged and has modest alterations, however, the one and one-half story form with a southern orientation and a gable end to the street remains. The house is one bay wide and six deep with a single-story rear or side ell extending from the east end of the main house. There is a shed roof porch on the south side of this ell. Windows have six-over-six sash set in plain frames and wood louvered shutters. The entrance is in the second bay from the southwest corner on the south side and displays a paneled door with a four-light transom and flanking plain pilasters with minimal caps carrying a deep plain entablature and projecting lintel. The Greek Revival wide corner posts with modest caps carry support the wide frieze, boxed cornice and returns. The most significant alterations are the long low shed roof dormer with five paired casement windows and the modern multi-light bay oriel replacing two window bays on the west side of the main entrance. The porch that lines the south side of the rear ell has turned posts and a plain balustrade. There is a single chimney at the ridge. The mid-sized, mid- to late-nineteenth century two-story, barn (MHC #664) is located southeast of the house near the rise of the land. The barn has a gable roof perpendicular to the street with the entrance, now overhead garage door, in the south side elevation. High over this garage door at the top of the second-story level is a five-light transom which may have been related to a barn door. The barn has wood clapboard siding, a six-over-six window in the peak, horizontal band of six-light windows in the southwest corner, and a shed roof addition extending from the east gable end. A chimney protrudes from the south slope of the barn roof.

#### HISTORICAL NARRATIVE see continuation sheet

Discuss the history of the building. Explain its associations with local (or state) history. Include uses of the building, and the role(s) the owners/occupants played within the community.

From the mid 1800s there were scattered farmsteads along Cordaville Road, the major north-south corridor connecting the Southborough Center with Cordaville, once that village expanded in the 1840s. Until then Cordaville Road only extended from Southborough Center to just south of the Turnpike (now Route 9). This dwelling may have begun as a five-bay center entranced cape oriented to the south. First known name associated with the property is **L. Williams** who is not listed in assessors reports. There are a couple of larger properties attributed to other Williamses in 1870, but none that appears to be as modest as this. In the late 1890s and early 1900s the property was the home of **Henry and Mary Sommerman** (also spelled Summerman). Henry Summerman worked as a bookbinder. The property was assessed to Mary A. "Sommerman" including a modest house, barn, and hen house on her 12-acre farm. Also she had a horse and fifty chickens. The 1971 survey attributes this property to W. Homes. This surveyor believes that the property at 196 Cordaville Road should be attributed to Homes. Map names corresponding to this property are Williams (1870) and Sommerman (1898).

#### BIBLIOGRAPHY and/or REFERENCES see continuation sheet

- Assessors Records: 1870, 1881, 1894, 1897, 1909
- Atlases/Maps: 1870 (L. Williams), 1898 (H. Sommerman)
- Directories: 1900, 1905, 1913.

Recommended for listing in the National Register of Historic Places. If checked, you must attach a completed National Register Criteria Statement form.







PI # 210  
 USG? man

Southborough  
 address 188 Cordaville Rd

original & present \_\_\_\_\_  
 present owner Price?  
 to public \_\_\_\_\_  
 Style \_\_\_\_\_

Literature \_\_\_\_\_ Indians \_\_\_\_\_ Source of date \_\_\_\_\_  
 Music \_\_\_\_\_ Other \_\_\_\_\_  
 Development of town/city \_\_\_\_\_ Architect \_\_\_\_\_  
 Architectural reason for inventorying: \_\_\_\_\_

OR part of Area # \_\_\_\_\_  
 3. CONDITION Excellent Good Fair Deteriorated Moved Altered Added \_\_\_\_\_

4. DESCRIPTION

FOUNDATION/BASEMENT: High Regular Low Material Stone

WALL COVER: Wood clapboard Brick Stone Other \_\_\_\_\_

ROOF: Ridge Gambrel Flat Hip Mansard \_\_\_\_\_  
 Tower Cupola Dormer windows Balustrade Grillwork \_\_\_\_\_

CHIMNEYS: 1 2 3 4 Center End Interior Irregular Cluster Elaborate

STORIES: 1 2 3 4 ATTACHMENTS: Wings Ell Shed \_\_\_\_\_

PORCHES: 1 2 3 4 \_\_\_\_\_ PORTICO \_\_\_\_\_ Balcony

FACADE: Gable end: Front/side Ornament \_\_\_\_\_

Entrance: Side Front: Center/Side Details: \_\_\_\_\_

Windows: Spacing: Regular/Irregular Identical/Varied

Corners: Plain Pilasters Quoins Cornerboards

5. Indicate location of building in relation to nearest cross streets and other buildings

6. Footage of structure from street \_\_\_\_\_  
 Property has \_\_\_\_\_ feet frontage on street

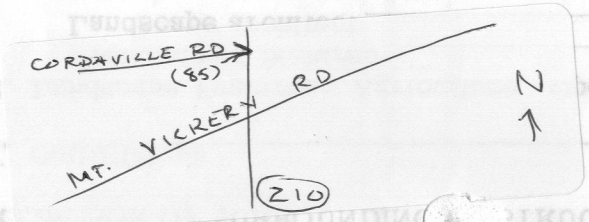

Recorder \_\_\_\_\_  
 For \_\_\_\_\_  
 Photo # 8-79 Date 1971  
 SEE REVERSE SIDE

RELATION OF SURROUNDING STRUCTURE

- 1. Outbuildings \_\_\_\_\_
- 2. Landscape Features: Agriculture Open Wooded Garden: Formal/Informal  
 Predominant features \_\_\_\_\_  
 Landscape architect \_\_\_\_\_
- 3. Neighboring Structures  
 Style: Colonial Federal Greek Revival Gothic Revival Italian Villa Lombard Rom.  
 Venetian Gothic Mansard Richardsonian Modern  
 Use: Residential Commercial Religious Conditions: Excellent Good Fair Deteriorated

GIVE A BRIEF DESCRIPTION OF HISTORIC IMPORTANCE OF SITE (Refer and elaborate on theme circled on front of form)

ROOF: Shingles

FOUNDATION/BASEMENT: Basement

4. DESCRIPTION

3. CONDITION Excellent Good Fair Deteriorated

BIBLIOGRAPHY AND/OR REFERENCE

1870 - "W. Homes"

Topic	Source of data	Date	Open to public	Present number	Use: original & present	Name	Street address
Music	Opera						
Philately	Postage						
Government	Religion/philosophy						
Education	Industry/arts						
Art/sculpture	Travel/communication						
Agriculture	Science/invention						
Sports	Commerce/industry						

following premises: (see also reverse side)  
Building has historical connection with the

RESTRICTIONS

Original Owner: \_\_\_\_\_  
 Deed Information: Book Number \_\_\_\_\_ Page \_\_\_\_\_, \_\_\_\_\_ Registry of Deeds