

Massachusetts Cultural Resource Information System

Scanned Record Cover Page

Inventory No:	SBR.197
Historic Name:	Mathews, John Jr. House
Common Name:	Burnett, Charles Ripley - Gilmore, Moses House
Address:	15 Gilmore Rd
City/Town:	Southborough
Village/Neighborhood:	
Local No:	12-2
Year Constructed:	c 1710
Architect(s):	
Architectural Style(s):	Georgian
Use(s):	Agricultural; Orchard; Secondary Dwelling House; Single Family Dwelling House
Significance:	Agriculture; Architecture; Exploration Settlement; Military; Recreation
Area(s):	
Designation(s):	
Building Materials(s):	Roof: Asphalt Shingle Wall: Wood Clapboard; Wood Foundation: Stone, Uncut



The Massachusetts Historical Commission (MHC) has converted this paper record to digital format as part of ongoing projects to scan records of the Inventory of Historic Assets of the Commonwealth and National Register of Historic Places nominations for Massachusetts. Efforts are ongoing and not all inventory or National Register records related to this resource may be available in digital format at this time.

The MACRIS database and scanned files are highly dynamic; new information is added daily and both database records and related scanned files may be updated as new information is incorporated into MHC files. Users should note that there may be a considerable lag time between the receipt of new or updated records by MHC and the appearance of related information in MACRIS. Users should also note that not all source materials for the MACRIS database are made available as scanned images. Users may consult the records, files and maps available in MHC's public research area at its offices at the State Archives Building, 220 Morrissey Boulevard, Boston, open M-F, 9-5.

Users of this digital material acknowledge that they have read and understood the MACRIS Information and Disclaimer (<http://mhc-macris.net/macrisdisclaimer.htm>)

Data available via the MACRIS web interface, and associated scanned files are for information purposes only. THE ACT OF CHECKING THIS DATABASE AND ASSOCIATED SCANNED FILES DOES NOT SUBSTITUTE FOR COMPLIANCE WITH APPLICABLE LOCAL, STATE OR FEDERAL LAWS AND REGULATIONS. IF YOU ARE REPRESENTING A DEVELOPER AND/OR A PROPOSED PROJECT THAT WILL REQUIRE A PERMIT, LICENSE OR FUNDING FROM ANY STATE OR FEDERAL AGENCY YOU MUST SUBMIT A PROJECT NOTIFICATION FORM TO MHC FOR MHC'S REVIEW AND COMMENT. You can obtain a copy of a PNF through the MHC web site (www.sec.state.ma.us/mhc) under the subject heading "MHC Forms."

Commonwealth of Massachusetts
Massachusetts Historical Commission
220 Morrissey Boulevard, Boston, Massachusetts 02125
www.sec.state.ma.us/mhc

This file was accessed on:

Friday, July 08, 2016 at 12:55 PM

FORM B – BUILDING

MASSACHUSETTS HISTORICAL COMMISSION
MASSACHUSETTS ARCHIVES BUILDING
220 MORRISSEY BOULEVARD
BOSTON, MASSACHUSETTS 02125

Assessor's Number USGS Quad Area(s) Form Number

12-2 Marlboro 197

Town SOUTHBOROUGH

Place (neighborhood or village)



15 Gilmore Road
Name John Mathews, Jr. House
Present residential - single family
Original residential
Construction early 1700s
History/Noble
Form Georgian
Architect/Builder unknown
Primary Material: stone
Foundation stone

Sketch Map

Draw a map showing the building's location in relation to the nearest cross streets and/or major natural features. Show all buildings between inventoried building and nearest intersection or natural feature. Label streets including route numbers, if any. Circle and number the inventoried building. Indicate north.

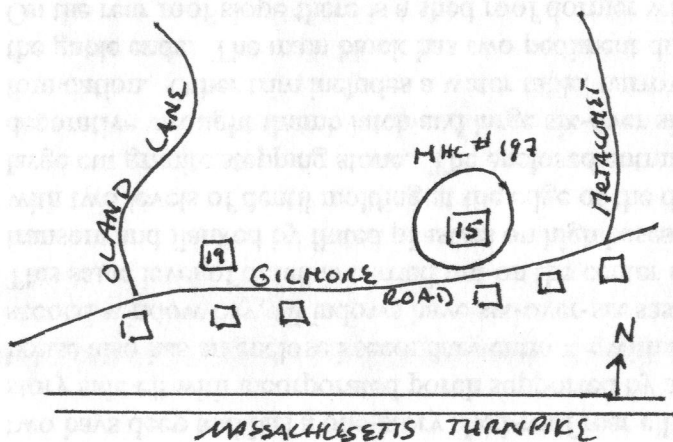

Wall/Trim wood clapboards/wood trim

Roof asphalt shingles

Outbuildings/Secondary Structures small flushboard shed, 3-car garage at road edge on stone built into slope w/ gable roof, cupola, 6/6 sash - probably re-used hen house or root cellar

Major Alterations (with dates) rear and side ells, dormers = early to mid 1900s

Condition good

Moved ☒ no ☐ yes Date n/a

Acreage One acre

Recorded by Schuler/Forbes, Consultants

Organization Southborough Historical Commission

Date (month/year) 2/00

Setting Rural setting next to early 19th c. dwelling across from 1950s ranch/capes and surrounded behind by new 1990s subdivision, high flat dry-laid stone wall with 5 steps in front and cluster of hemlocks on each side of steps, side line stone wall between 15 and 19 Gilmore.

JUL 03 2000

BUILDING FORM**ARCHITECTURAL DESCRIPTION**☐ see continuation sheet*Describe architectural features. Evaluate the characteristics of this building in terms of other buildings within the community.*

The wide five-bay, two and one-half story dwelling rests on a parged stone foundation and is capped with a side gable roof from which protrudes a centered chimney placed just in front of the ridge. The wide main block is two bays deep and has a one-story shed-roof rear ell that extends from just under the rear eave and a long one-story side ell with incorporated porch supported by square columns extending to the west from the rear ell. The house also has an enclosed secondary entrance with a pedimented gable roof on the west elevation in place of the second window bay. Windows have six-over-six sash set in molded frames with projecting molded crown lintels. This same level of detail is carried out on the center entrance - a raised 12-paneled door topped by a six-light transom and flanked by fluted pilasters on high bases that support a full templar pediment, which is ornamented with two levels of dentil molding at the edge of the deep projection of the cornice. At the front door there is a large cut granite stepping stone. The enclosed entrance on the left side has a raised field six-panel door with a decorative wrought thumb latch and large six-over six sash on the sides of the enclosure all on a parged stone foundation. Other trim includes a water table, narrow corner boards, and boxed cornice with narrow returns in the gable ends. The main block has two pediment dormers on the front slope each with one six-over six sash. On the rear roof slope there is a shed roof dormer with two four-over-four windows. It is reported that interior features include a hidden second stairs in the room to the left of the front door, now used as a dining room. Interior investigation is necessary to confirm and refine the early-to mid-eighteenth century construction date which now is derived through historical information.

HISTORICAL NARRATIVE☒ see continuation sheet*Discuss the history of the building. Explain its associations with local (or state) history. Include uses of the building, and the role(s) the owners/occupants played within the community.*

Southborough was part of Marlborough, and was known as Stony Brook from the time of the original land grant of 1660 to the establishment of the town in 1727. Thus early settlers of Gilmore Road were Marlborough residents. Throughout the eighteenth century the southern part of Southborough had scattered farmsteads and some saw and grist mills with the few dwellings along Gilmore, Richards, and Oregon Roads.

Oral tradition states that this was the second Mathis (aka Mathews) garrison house at Stonybrook. The first, sited slightly north of this dwelling, had been built in ca. 1688 by John Mathis for him and his wife, Mary Johnson, the daughter of a Marlborough blacksmith. It was one of three known garrison houses in Stony Brook (Southborough) prior to 1700. Mathis was referred to as "Doctor" for some training and ability to help sick persons and animals. He also was a brewer. This second garrison house reportedly was built by Dr. Mathis' son, John Mathews, Jr. in ca. 1710 according to local histories. Both father and son were signers of petitions to separate from Marlborough and establish the town of Southborough. In 1749 Daniel Mathis (d. 1755) (the only Mathis or Mathews in the 1749 Census) had six acres of pasturage, one and one-half acres of orchard, eight acres of tillage land, and nineteen acres of mowing land. He also produced cider, corn and grain, and hay. The late eighteenth century owner was Asahel Mathis (1732-1811) (aka Mathews), who was the son of Daniel and Eunice Mathis. Asahel Mathis' daughter, Lovina, married Charles Ripley Burnett in 1783. The Burnetts lived at this farm from ca. 1790. In part, this accounts for the 1790 census noting two males over the age of 16 years, one under 16 and six females in Asahel Mathews household. In 1791 Asahel Mathews, gentleman, conveyed the

INVENTORY FORM CONTINUATION SHEETTown
SOUTHBOROUGHProperty Address
15 GILMORE ROAD
Area(s) Form No.MASSACHUSETTS HISTORICAL COMMISSION
MASSACHUSETTS ARCHIVES BUILDING
220 MORRISSEY BOULEVARD
BOSTON, MASSACHUSETTS 02125

197

HISTORICAL NARRATIVE (Continued)

homestead and approximately 180 acres of land to Charles R. Burnett, yeoman of Barre for 750 Pounds Sterling. The 1798 Direct Tax Census attributed eighteen acres, a dwelling house, and one outbuilding to Mathews and a house and one acre to Charles Burnett. Additional research is needed to clarify this recording. Burnett, a teamster, drove a Hopkinton wagon in the Revolutionary War effort to move supplies between Boston and Springfield and on to Connecticut. One of the stopping places en route was at Asahel Mathews house. Charles and Lovina Burnett raised their children here and were the parents and grandparents of at least two important Southborough citizens, Dr. Joel Burnett, educator and founder of the Lyceum, and Joseph Burnett, founder of St. Mark's School and Church. There is a listing in the 1850 Agricultural Census for Charles Burnett, who had lived at **19 Gilmore Road**, from about the time of his marriage. However, it appears by map and census information that Burnett no longer lived at 19 Gilmore Road in 1850. Thus he may have returned to this family homestead in which he had been born. On his 25-acre farm he had a horse, cow, pair of oxen, and one swine and produced small amounts of rye, Indian corn, hay, peas and beans, and Irish potatoes. Based on the production of other Southborough farms, Burnett's farm was modest. Two generations of Gilmores lived here from the 1850s. In 1860 both Moses and Nelson Gilmore were assessed for \$1800 worth of real estate. It is unclear who lived here at that time as the 1857 map states "M. Gilmore" and the 1870 map "N. Gilmore". Nelson Gilmore (1828-1872) was the son of Moses Gilmore (1802-1861). The 1870 assessors report assessed Gilmore, who was a farmer, for a house, barn, cider mill house, and granary on a 107 acre farm. This was a large farm compared to others. Besides farming Nelson Gilmore, like other local farmers, also worked for the town at times. In 1860 he was paid for locating schoolhouses and for the laying out of town ways. Gilmore, who with Caleb S. Williams and Warren Parmenter was a Highway Supervisor, was paid for 33 days of labor including the use of his pair of oxen and horse in 1865. The work completed was the laying of chestnut poles for railing the highways. It is likely that Geraldine Ward Gilmore (1830-1910) who was assessed for a farm with house, barn and toolhouse was the widow of Nelson Gilmore who died in 1872. Further research is necessary to account for Harriet Taylor's Heirs who owned the property in the late 1890s. In the 1920s this property was the summer home of General Morris Schaff, whose wife befriended the Olands at **19 Gilmore Road** and was quoted in Warner Oland's 1938 obituary. It was not uncommon in the early 1900s to have eighteenth and nineteenth century farmhouses in outlying towns used as summer houses.

BIBLIOGRAPHY and/or REFERENCES☒ *see continuation sheet*

Assessors Records: 1860, 1870, 1881, 1894, 1897.

Atlases/Maps; 1831, 1857 (M. Gilmore), 1870 (N. Gilmore), 1898 (Harriet Taylor, Heirs).

Town Census: 1749, 1790.

Federal Direct Tax Census: 1798

Noble, Richard. Fences of Stone, 1990.

INVENTORY FORM CONTINUATION SHEET

Town
SOUTHBOROUGH

Property Address
15 GILMORE ROAD
Area(s) Form No.

MASSACHUSETTS HISTORICAL COMMISSION
MASSACHUSETTS ARCHIVES BUILDING
220 MORRISSEY BOULEVARD
BOSTON, MASSACHUSETTS 02125

	197
--	-----

BIBLIOGRAPHY and/or REFERENCES (Continued)

Southborough Historical Society. Old Southborough: A Photographic Essay.
Vital Records to 1850.

☒ Recommended for listing in the National Register of Historic Places. *If checked, you must attach a completed National Register Criteria Statement form.*



Entrance detail

MASSACHUSETTS HISTORICAL COMMISSION
MASSACHUSETTS ARCHIVES BUILDING
220 MORRISSEY BOULEVARD
BOSTON, MASSACHUSETTS 02125

Community Property Address
SOUTHBOROUGH 15 GILMORE RD.

Area(s) Form No.

	197
--	-----

National Register of Historic Places Criteria Statement Form

Check all that apply:

- ☒ Individually eligible ☐ Eligible **only** in a historic district
☒ Contributing to a potential historic district ☐ Potential historic district

Criteria: ☒ A ☐ B ☒ C ☐ D

Criteria Considerations: ☐ A ☐ B ☐ C ☐ D ☐ E ☐ F ☐ G

Statement of Significance by Schuler/Forbes, Consultants
The criteria that are checked in the above sections must be justified here.

The John Mathews House is the only early to mid eighteenth century dwelling remaining in this area of southern section of Southborough and is reminiscent of the development patterns of the Town. Although the surrounding land has been recently developed the architecture is important and displays one of the best local examples of the Georgian Style. The property's association with one of the early families also is important. This property is eligible for listing individually and as part of a district with the Charles Burnett House at 19 Gilmore Road. It retains integrity of location, design, materials, workmanship, association and feeling.



Probably oldest house in town 1977 x

Pls man

wn Southborough

reet address 15 Gilmore Road

ame Garrison House

se: original & present Dwelling

resent owner Doer

Open to public _____

ate 1690 Style _____

ource of date Moulton Records

rchitect _____

Architectural reason for inventorying: _____

OR part of Area # _____

3. CONDITION Excellent Good Fair Deteriorated Moved Altered Added _____

4. DESCRIPTION

FOUNDATION/BASEMENT: High Regular Low Material Fieldstone

WALL COVER: Wood Clapboard Brick Stone Other _____

ROOF: Ridge Gambrel Flat Hip Mansard _____

Tower Cupola Dormer windows Balustrade Grillwork _____

CHIMNEYS: 1 2 3 4 Center End Interior Irregular Cluster Elaborate

STORIES: 1 2 3 4 ATTACHMENTS: Wings Ell Shed _____

PORCHES: 1 2 3 4 PORTICO _____ Balcony _____

FACADE: Gable end: Front/side Ornament _____

Entrance: Side Front: Center Side Details: _____

Windows: Spacing: Regular Irregular Identical Varied _____

Corners: Plain Pilasters Quoins Cornerboards _____

5. Indicate location of building in relation to nearest cross streets and other buildings

6. Footage of structure from street _____
Property has _____ feet frontage on street

Recorder _____

For _____

Photo # 571 Date 1977

SEE REVERSE SIDE

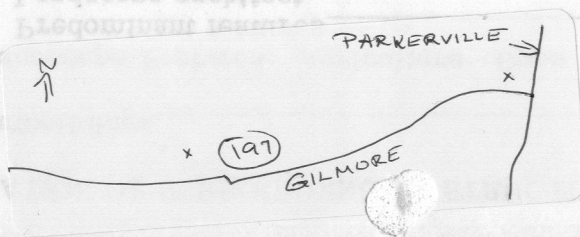

RELATION OF SURROUNDING STRUCTURE

5BR.197

1. Outbuildings _____
2. Landscape Features: Agriculture Open Wooded Garden: Formal/Informal
Predominant features _____
Landscape architect _____

3. Neighboring Structures
Style: Colonial Federal Greek Revival Gothic Revival Italian Villa Lombard Rom.
Venetian Gothic Mansard Richardsonian Modern
Use: Residential Commercial Religious Conditions: Excellent Good Fair Deteriorated

GIVE A BRIEF DESCRIPTION OF HISTORIC IMPORTANCE OF SITE (Refer and elaborate on theme circled on front of form)

Old garrison house - only one left, most of the others were burned

BIBLIOGRAPHY AND/OR REFERENCE

1870 Atlas - N. Gilmore

RESTRICTIONS

Original Owner: _____
Deed Information: Book Number _____ Page _____, _____ Registry of Deeds