

Massachusetts Cultural Resource Information System

Scanned Record Cover Page

Inventory No:	SBR.65
Historic Name:	Hildreth, Lawson - Fay, Waldo A. House
Common Name:	Sharp House
Address:	134 Deerfoot Rd
City/Town:	Southborough
Village/Neighborhood:	Southborough
Local No:	18-1A
Year Constructed:	c 1870
Architect(s):	Hildreth
Architectural Style(s):	No style
Use(s):	Single Family Dwelling House
Significance:	Architecture
Area(s):	
Designation(s):	
Building Materials(s):	Roof: Asphalt Shingle Wall: Wood Clapboard; Wood Foundation: Stone, Uncut



The Massachusetts Historical Commission (MHC) has converted this paper record to digital format as part of ongoing projects to scan records of the Inventory of Historic Assets of the Commonwealth and National Register of Historic Places nominations for Massachusetts. Efforts are ongoing and not all inventory or National Register records related to this resource may be available in digital format at this time.

The MACRIS database and scanned files are highly dynamic; new information is added daily and both database records and related scanned files may be updated as new information is incorporated into MHC files. Users should note that there may be a considerable lag time between the receipt of new or updated records by MHC and the appearance of related information in MACRIS. Users should also note that not all source materials for the MACRIS database are made available as scanned images. Users may consult the records, files and maps available in MHC's public research area at its offices at the State Archives Building, 220 Morrissey Boulevard, Boston, open M-F, 9-5.

Users of this digital material acknowledge that they have read and understood the MACRIS Information and Disclaimer (<http://mhc-macris.net/macrisdisclaimer.htm>)

Data available via the MACRIS web interface, and associated scanned files are for information purposes only. THE ACT OF CHECKING THIS DATABASE AND ASSOCIATED SCANNED FILES DOES NOT SUBSTITUTE FOR COMPLIANCE WITH APPLICABLE LOCAL, STATE OR FEDERAL LAWS AND REGULATIONS. IF YOU ARE REPRESENTING A DEVELOPER AND/OR A PROPOSED PROJECT THAT WILL REQUIRE A PERMIT, LICENSE OR FUNDING FROM ANY STATE OR FEDERAL AGENCY YOU MUST SUBMIT A PROJECT NOTIFICATION FORM TO MHC FOR MHC'S REVIEW AND COMMENT. You can obtain a copy of a PNF through the MHC web site (www.sec.state.ma.us/mhc) under the subject heading "MHC Forms."

Commonwealth of Massachusetts
Massachusetts Historical Commission
220 Morrissey Boulevard, Boston, Massachusetts 02125
www.sec.state.ma.us/mhc

This file was accessed on:

Friday, July 08, 2016 at 12:25 PM

FORM B – BUILDING

MASSACHUSETTS HISTORICAL COMMISSION
MASSACHUSETTS ARCHIVES BUILDING
220 MORRISSEY BOULEVARD
BOSTON, MASSACHUSETTS 02125

Assessor's Number USGS Quad Area(s) Form Number

18-1A

Marlboro

65

BARN - #658

Town SOUTHBOROUGH

Place (neighborhood or village)



s 134 Deerfoot Road

c Name Lawson Hildreth House

Present residential

Original residential

Construction ca. 1870

maps

form no style

ct/Builder unknown

r Material:

Foundation stone

Wall/Trim wood clapboards/wood trim

Roof asphalt shingle

Outbuildings/Secondary Structures Gable front barn with attached two car sheds/garage - barn has large door with segmental transom and two windows in the peak.

Major Alterations (with dates) Additions to house, exterior chimney, window changes.

Condition good

Moved ☒ no ☐ yes Date n/a

Acreage 1 acre

Setting At the end of a rural road just off Turnpike Road (Route 9), set back on a spacious lot with mature plantings, stone wall edging much of property. Post and rail section across a former entrance. Only a few houses on this section of Deerfoot, one 18th c. and a two modern dwellings not visible from road.

Sketch Map

Draw a map showing the building's location in relation to the nearest cross streets and/or major natural features. Show all buildings between inventoried building and nearest intersection or natural feature. Label streets including route numbers, if any. Circle and number the inventoried building. Indicate north.

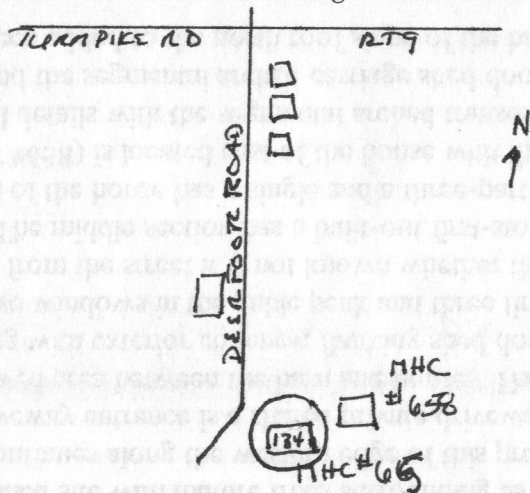

Recorded by Schuler/Forbes

Organization Southborough Historical Commission

Date (month/year) 3/00

RECEIVED

JUL 03 2000

Follow Massachusetts Historical Commission Survey Manual instructions for completing this form.

MASS. HIST. COMM

BUILDING FORM**ARCHITECTURAL DESCRIPTION**☐ see continuation sheet

Describe architectural features. Evaluate the characteristics of this building in terms of other buildings within the community.

The Hildreth Farm is at the end of that part of Deerfoot Road south of Turnpike Road (Route 9), although the road extended farther south and west throughout the nineteenth century. The house and barn are on a well established site with mature trees surrounding as well as trimmed shrubbery. The paved road ends and the dirt road continues along the western edge of this property which is marked by a low stone wall as well. Presently the driveway entrance is a shared private driveway which runs slightly north of this property and turns in to lead to a paved area between the barn and house. The earliest section probably is the gable roof west end of this dwelling with exterior chimney, flanking shed dormers with small six-light windows and a northwest gable end with two windows in the gable peak and three first-story windows. The dwelling has been substantially altered so that from the street it is not known whether the original dwelling had a gable front facade oriented toward the barn. The middle section has a built-out first-story entrance and second-story paired windows. The eastern most section of the house has a single and a three-part modern window at the first story level. The gable front barn (MHC #658) is located east of the house with the driveway between the two buildings. The barn has Colonial Revival details with the segmental arched transom over the large centered sliding door, the paired sash in the peak and the segmental arched carriage shed doors on the attached garage. A shed roof dormer and chimney have been added to the north roof slope of the barn.

HISTORICAL NARRATIVE☐ see continuation sheet

Discuss the history of the building. Explain its associations with local (or state) history. Include uses of the building, and the role(s) the owners/occupants played within the community.

This short spur of a road appears on the earliest 1831 map with three houses at that time of which only the Fay House at 135 Deerfoot Road remains. This property was not constructed until after 1857 at which time it did not yet appear on the map. By ca. 1870 when **Lawson Hildreth** had this simple house on a two and one-half acre lot it was only the fourth dwelling on this road. Today only two of those four remain. By 1881 Hildreth also had a barn on his property. The road extended slightly farther south to one of the Deerfoot Farm Company properties which is no longer extant. Today remnants of that part of the road remain unpaved and running along the western boundary of this property. By 1900 Hildreth, who was listed as a carpenter in the Street Directory, lived on the road to Fayville. However it is known that he owned this property from ca. 1870 to 1898. Also in 1900 a Charles C. Hildreth who lived on McQuarrie Road, now known as Clifford Road at the north end of Deerfoot Road, was listed as a carpenter. It is possible that this family of carpenters built this house prior to 1870. After Hildreth this property may have been connected with the **Fay House** at 135 Deerfoot Road as a farmer's house or the house in which Waldo A. Fay, administrator of John A.J. Fay's property. He remained on Deerfoot Road in a modest house with barn after Fay's twentieth century successor at 135 Deerfoot Road had arrived. Additional research would be necessary to determine whether there was a connection between the two properties.

BIBLIOGRAPHY and/or REFERENCES☐ see continuation sheet

Assessors Reports: 1870, 1881, 1894, 1897.

Atlases/Maps: 1870 (L. Hildreth), 1898 (L. Hildreth)

Directories: 1900, 1903, 1905.

Noble, Richard. Fences of Stone, 1990.

☒ Recommended for listing in the National Register of Historic Places. *If checked, you must attach a completed National Register Criteria Statement form.*

MASSACHUSETTS HISTORICAL COMMISSION
MASSACHUSETTS ARCHIVES BUILDING
220 MORRISSEY BOULEVARD
BOSTON, MASSACHUSETTS 02125

Community Property Address
SOUTHBOROUGH 134 DEERFOOT RD.

Area(s) Form No.

	65
--	----

National Register of Historic Places Criteria Statement Form

Check all that apply:

- ☐ Individually eligible ☒ Eligible **only** in a historic district
☐ Contributing to a potential historic district ☐ Potential historic district

Criteria: ☒ A ☐ B ☒ C ☐ D

Criteria Considerations: ☐ A ☐ B ☐ C ☐ D ☐ E ☐ F ☐ G

Statement of Significance by Schuler/Forbes, Consultants
The criteria that are checked in the above sections must be justified here.

The Lamson Hildreth House is one of only two remaining properties on this section of Deerfoot Road that is reminiscent of the argicultural past of the area. Although the main house has been altered it retains it setting and barn and displays the effect of the Colonial Revival period on rural farmhouses. This property is eligible for listing only as part of a district with the Moses Fay House at 135 Deerfoot Road. It retains integrity of location, setting, design, association and feeling.



Pl. SOUTH 65
134-1342
Southborough
Address 134-Deerfoot Rd
Original & present dwelling
Owner Col. Edwin McMeen
public
Style

Literature Indians Source of date
Music Other
Development of town/city Architect
Architectural reason for inventorying:
Pre 1870 OR part of Area #

3. CONDITION Excellent Good Fair Deteriorated Moved Altered Added

4. DESCRIPTION

FOUNDATION/BASEMENT: High Regular Low Material Stone

WALL COVER: Wood Clefboard Brick Stone Other

ROOF: Ridge Gambrel Flat Hip Mansard
Tower Cupola Dormer windows Balustrade Grillwork

CHIMNEYS: 1 2 3 4 Center End Interior Irregular Cluster Elaborate

STORIES: 1 2 3 4 ATTACHMENTS: Wings Ell Shed

PORCHES: 1 2 3 4 PORTICO Balcony

FACADE: Gable end: Front/side Ornament

Entrance: Side Front: Center/Side Details:

Windows: Spacing: Regular/Irregular Identical/Varied

Corners: Plain Pilasters Quoins Cornerboards

5. Indicate location of building in relation to nearest cross streets and other buildings

6. Footage of structure from street
Property has feet frontage on street

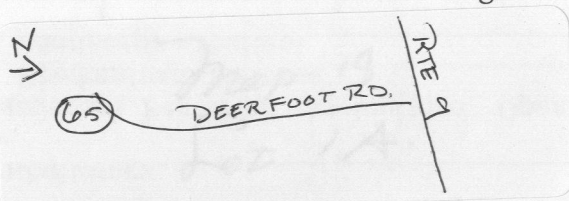

Recorder

For

Photo # 2-24 Date 1971

SEE REVERSE SIDE

RELATION OF SURROUNDING STRUCTURE

SBR.65

1. Outbuildings

2. Landscape Features: Agriculture Open Wooded Garden: Formal/Informal

Predominant features

Landscape architect

3. Neighboring Structures

Style: Colonial Federal Greek Revival Gothic Revival Italian Villa Lombard Rom.

Venetian Gothic Mansard Richardsonian Modern

Use: Residential Commercial Religious

Conditions: Excellent Good Fair Deteriorated

GIVE A BRIEF DESCRIPTION OF HISTORIC IMPORTANCE OF SITE (Refer and elaborate on theme circled on front of form)

BIBLIOGRAPHY AND/OR REFERENCE

1898 L. Hildreth

also

Sharp

RESTRICTIONS

Original Owner:

Deed Information: Book Number 4450 Page 447, Worcester Co. Registry of Deeds