

# Massachusetts Cultural Resource Information System

## Scanned Record Cover Page

<b>Inventory No:</b>	SBR.80
<b>Historic Name:</b>	Muchmore, William House
<b>Common Name:</b>	Proctor, Dr. - Simpson, Willard C. House
<b>Address:</b>	12 Middle Rd
<b>City/Town:</b>	Southborough
<b>Village/Neighborhood:</b>	Southborough
<b>Local No:</b>	54-17
<b>Year Constructed:</b>	
<b>Architect(s):</b>	Simpson, Willard C.
<b>Architectural Style(s):</b>	Colonial; Greek Revival
<b>Use(s):</b>	Agricultural; Single Family Dwelling House
<b>Significance:</b>	Agriculture; Architecture
<b>Area(s):</b>	
<b>Designation(s):</b>	
<b>Building Materials(s):</b>	Roof: Asphalt Shingle Wall: Vinyl Siding; Wood Foundation: Stone, Uncut; Granite; Concrete Unspecified



The Massachusetts Historical Commission (MHC) has converted this paper record to digital format as part of ongoing projects to scan records of the Inventory of Historic Assets of the Commonwealth and National Register of Historic Places nominations for Massachusetts. Efforts are ongoing and not all inventory or National Register records related to this resource may be available in digital format at this time.

The MACRIS database and scanned files are highly dynamic; new information is added daily and both database records and related scanned files may be updated as new information is incorporated into MHC files. Users should note that there may be a considerable lag time between the receipt of new or updated records by MHC and the appearance of related information in MACRIS. Users should also note that not all source materials for the MACRIS database are made available as scanned images. Users may consult the records, files and maps available in MHC's public research area at its offices at the State Archives Building, 220 Morrissey Boulevard, Boston, open M-F, 9-5.

Users of this digital material acknowledge that they have read and understood the MACRIS Information and Disclaimer (<http://mhc-macris.net/macrisdisclaimer.htm>)

Data available via the MACRIS web interface, and associated scanned files are for information purposes only. THE ACT OF CHECKING THIS DATABASE AND ASSOCIATED SCANNED FILES DOES NOT SUBSTITUTE FOR COMPLIANCE WITH APPLICABLE LOCAL, STATE OR FEDERAL LAWS AND REGULATIONS. IF YOU ARE REPRESENTING A DEVELOPER AND/OR A PROPOSED PROJECT THAT WILL REQUIRE A PERMIT, LICENSE OR FUNDING FROM ANY STATE OR FEDERAL AGENCY YOU MUST SUBMIT A PROJECT NOTIFICATION FORM TO MHC FOR MHC'S REVIEW AND COMMENT. You can obtain a copy of a PNF through the MHC web site ([www.sec.state.ma.us/mhc](http://www.sec.state.ma.us/mhc)) under the subject heading "MHC Forms."

Commonwealth of Massachusetts  
Massachusetts Historical Commission  
220 Morrissey Boulevard, Boston, Massachusetts 02125  
[www.sec.state.ma.us/mhc](http://www.sec.state.ma.us/mhc)

This file was accessed on:

Saturday, July 09, 2016 at 12:52 PM

## FORM B - BUILDING

Assessor's number

USGS Quad

Area(s)

Form Number

Massachusetts Historical Commission  
 Massachusetts Archives Building  
 220 Morrissey Boulevard  
 Boston, MA 02125

54-17

Marlborough

80

Town Southborough

Place (neighborhood or village) \_\_\_\_\_

Southborough centerAddress 12 Middle RoadHistoric Name William Muchmore HouseUses: Present dwellingOriginal dwellingDate of Construction late 18th centurySource visual assessment; local researchStyle/Form Colonial half-house, updated to  
Greek RevivalArchitect/Builder unknown

## Exterior Material:

Foundation granite and concreteWall/Trim vinyl sidingRoof asphalt

Outbuildings/Secondary Structures \_\_\_\_\_

noneMajor Alterations (with dates) enlargedca. 1900; updated ca. 1830s. (see text)Condition goodMoved [ ] no [x] yes Date after 1831Acreage less than one acreSetting Upper end of Middle Rd., opposite FaySchool campus. Cemetery to rear.

## Sketch Map

Draw a map of the area indicating properties within it. Number each property for which individual inventory forms have been completed. Label streets, including route numbers, if any. Attach a separate sheet if space is not sufficient here. Indicate north.

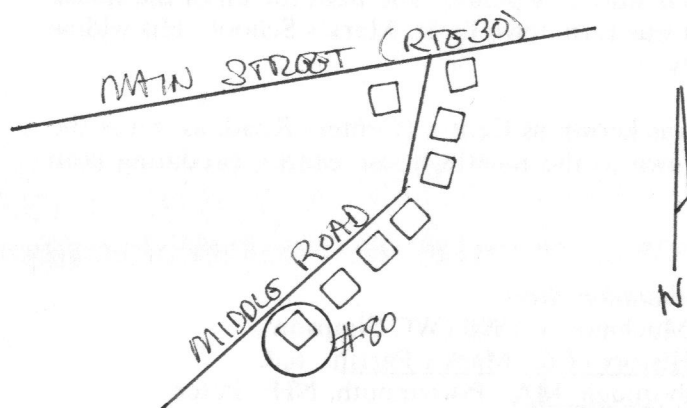
Recorded by Forbes/Schuler, consultantsOrganization Southborough Historical CommissionDate JUL 03 2000  
February, 2000

MASS. HIST. COMM

ARCHITECTURAL DESCRIPTION ☐ *see continuation sheet*

*Describe architectural features. Evaluate the characteristics of this building in terms of other buildings within the community.*

This little two-story, side-gabled, three-bay half-house is one of the few eighteenth-century half-houses remaining in Southborough. There may once have been many more, but as it was common to expand this type of one-room-plan building into a full five-bay house, most would be unrecognizable today. The south elevation of the main part of the building is symmetrically arranged, two-bays-deep; the north end has only one attic-level window under the gable peak, and one second-story window toward the rear of the elevation. A cross-gabled ell of one-story height in the north portion, and two stories at the south, abuts the rear of the old house. The ell is one bay deep on the north and two bays on the south, and is abutted on the rear by a modern deck.

The windows are 6-over-6-sash, in slightly projecting, simple board surrounds, and have modern wood louvered shutters. The casings of the three windows on the second story of the facade abut the lower edge of the narrow frieze. The front cornice is molded and boxed, but has no returns or trim at the gable ends. The main entry, in the northernmost bay of the facade, has a 6-panel door in a ca. 1830s surround with diamond-pane sidelights over paneled aprons, with pilasters adorned with a Greek key motif, molded capitals, and a two-part frieze with architrave molding.

HISTORICAL NARRATIVE ☐ *see continuation sheet*

*Explain history of the building. Explain its associations with local (or state) history. Include uses of the building, and the role(s) the owners/occupants played within the community.*

This building is one of the two earliest houses on the north part of Middle Road at Southborough center. Local research has indicated that it dates to 1787. Since no building appears at this location on the map of 1831, however, it is likely that the house was moved from another location.

In the middle of the nineteenth century it was the home of **William Muchmore**, who had a tiny farm of two acres here. In 1870 he kept two cows and a pig. There was a woodshed on the property, and the barn stood close to the road, just south of the house. By 1881 Mr. Muchmore had expanded the property to ten acres. Like many residents of the center, he also owned some tillage land and woodland at another location in town.

By 1897 the property was owned by farmer **Willard C. Simpson**, who had a piggery on the property. For many years he was sexton of St. Mark's Church. He was also a carpenter, and built the ell of the house with lumber from the Timothy Brigham House after it was torn down by St. Mark's School. His widow or daughter, **Louisa H. Simpson**, inherited the property.

Until the turn of the twentieth century, Middle Road was known as Centre (Center) Road, as it was the primary route that cut north through the middle of town to the meetinghouse center, predating both Cordaville and Parkerville Roads.

BIBLIOGRAPHY and/or REFERENCES ☐ *see continuation sheet*

- Maps and Atlases: 1857 (W. Muchmore); 1870 (W. Muchmore); 1898 (WC Simpson).  
 Goll, Rev. Harry E. Pater Noster & Paternalism: a History of St. Mark's Parish. n.d.  
 Noble, Richard. Fences of Stone: a History of Southborough, MA. Portsmouth, NH: Peter Randall, 1990.  
 Owners' research.  
Westborough, Northborough, and Southborough Directory. 1905.  
The Marlborough Directory. Various dates and publishers.  
 Town of Southborough: Vital Records; Annual Reports and Tax Valuations, various dates.

[x] Recommended for listing in the National Register of Historic Places. *If checked, a completed National Register Criteria Statement form is attached.*

Massachusetts Historical Commission  
220 Morrissey Boulevard  
Boston, Massachusetts 02125

Community  
Southborough

Property Address  
12 Middle Road

Area(s)

Form No(s).  
80

## National Register of Historic Places Criteria Statement Form

Check all that apply:

☐ Individually eligible    ☐ Eligible only in a historic district  
☒ Contributing to a potential historic district    ☐ Potential historic district

Criteria: ☒ A    ☐ B    ☒ C    ☐ D

Criteria Considerations:    ☐ A    ☐ B    ☐ C    ☐ D    ☐ E    ☐ F    ☐ G

Statement of Significance by Forbes/Schuler, Consultants  
*The criteria that are checked in the above sections must be justified here.*

This house is eligible for the National Register at the local level as a contributing property in a district encompassing the historic residential and institutional meetinghouse center of the town. Under Criterion A, it is significant of the early development of land just south of Main Street opposite the meetinghouse and common, when a few late-eighteenth- and early-nineteenth-century farms occupied the land along Middle Road between the town center and the south loop of Stony Brook. It meets Criterion C as an example of a late-eighteenth-century half-house.

The property retains integrity of location, design, workmanship, feeling, setting and association.



80

Pl South  
1105 mtr

Southborough  
12 Middle Rd.  
dwelling  
Ernest Howarth  
no  
1782  
dual

Architectural reason for inventorying:

Pro 1870

OR part of Area #

3. CONDITION Excellent Good Fair Deteriorated Moved Altered Added in 1900

#### 4. DESCRIPTION

FOUNDATION/BASEMENT: High Regular Low Material Fieldstone

WALL COVER: Wood clapboard Brick Stone Other

ROOF: Ridge Gambrel Flat Hip Mansard  
Tower Cupola Dormer windows Balustrade Grillwork

CHIMNEYS: 1 2 3 4 Center End Interior Irregular Cluster Elaborate

STORIES: 1 2 3 4 ATTACHMENTS: Wings Ell Shed

PORCHES: 1 2 3 4 PORTICO Balcony

FACADE: Gable end: Front side Ornament

Entrance: Side Front: Center side Details: glass side windows sidelights

Windows: Spacing: Regular Irregular Identical Varied

Corners: Plain Pilasters Quoins Cornerboards

5. Indicate location of building in relation to nearest cross streets and other buildings

6. Footage of structure from street  
Property has feet frontage on street

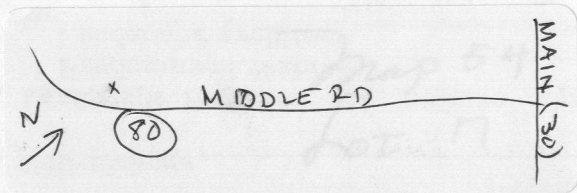

Recorder

For

Photo # 3-4 Date 1971

SEE REVERSE SIDE

## RELATION OF SURROUNDING STRUCTURE

1. Outbuildings \_\_\_\_\_
2. Landscape Features: Agriculture Open Wooded Garden: Formal/Informal  
 Predominant features \_\_\_\_\_  
 Landscape architect \_\_\_\_\_
3. Neighboring Structures  
 Style: Colonial Federal Greek Revival Gothic Revival Italian Villa Lombard Rom.  
 Venetian Gothic Mansard Richardsonian Modern

Use: Residential Commercial Religious Conditions: Excellent Good Fair Deteriorated

GIVE A BRIEF DESCRIPTION OF HISTORIC IMPORTANCE OF SITE (Refer and elaborate on theme circled on front of form)

owner has original deed

## BIBLIOGRAPHY AND/OR REFERENCE

Atlas

~~1898~~ 1898 - W.C. Simpson

Dr. Proctor

also

Truesdale (Tree warden 1970)

Dr. Hallisey

## RESTRICTIONS

Original Owner: \_\_\_\_\_

Deed Information: Book Number 4358 Page 424, Worcester co. Registry of Deeds